

KANEX[®]

Shaping the future of Fire Protection



STEP INSIDE THE SAFEZONE

PRODUCT

SPARE PARTS LIST

POWDER STORED PRESSURE EXTINGUISHERS - 1 & 2 KG (MS BODY)	03
POWDER STORED PRESSURE EXTINGUISHERS - 4, 6 & 9 KG (MS BODY)	04
POWDER STORED PRESSURE EXTINGUISHERS - 2 KG (SS BODY)	05
POWDER STORED PRESSURE EXTINGUISHERS - 4 & 6 KG (SS BODY)	06
POWDER CARTRIDGE PRESSURE EXTINGUISHERS - 4,6 & 9 KG	07
CLEAN AGENT STORED PRESSURE EXTINGUISHERS - 2 KG (MS BODY)	08
CLEAN AGENT STORED PRESSURE EXTINGUISHERS - 4 & 6 KG (MS BODY)	09
CLEAN AGENT STORED PRESSURE EXTINGUISHERS - 2,4 & 6 KG (SS BODY)	10
MECHANICAL FOAM STORED PRESSURE EXTINGUISHERS - 6 & 9 LTR (MS BODY)	11
MECHANICAL FOAM STORED PRESSURE EXTINGUISHERS - 6 & 9 LTR (SS BODY)	12
MECHANICAL FOAM CARTRIDGE PRESSURE EXTINGUISHERS - 6 & 9 LTR (MS BODY)	13
WATER FOAM STORED PRESSURE EXTINGUISHERS - 6 & 9 LTR (MS BODY)	14
WATER FOAM STORED PRESSURE EXTINGUISHERS - 6 & 9 LTR (SS BODY)	15
WATER FOAM CARTRIDGE PRESSURE EXTINGUISHERS - 6 & 9 LTR (MS BODY)	16
CARBON DIOXIDE PORTABLE EXTINGUISHERS - 1,2 & 3 KG	17
CARBON DIOXIDE PORTABLE EXTINGUISHERS - 4.5 KG	18
F CLASS KITCHEN FIRE EXTINGUISHER - 2,3,4,6 & 9 LTR (SS BODY)	19
D CLASS METAL STORED PRESSURE FIRE EXTINGUISHERS - 4,6 & 9 KG (MS BODY)	20
POWDER TROLLEY MOUNTED TYPE EXTINGUISHERS - 25, 50, 75 & 150 KG	21
D CLASS METAL TROLLEY MOUNTED TYPE EXTINGUISHERS - 25, 50 & 75 KG	22
CARBON DIOXIDE TROLLEY MOUNTED FIRE EXTINGUISHER - 6.5, 9, 22.5 & 45 KG	23
MECHANICAL FOAM TROLLEY MOUNTED FIRE EXTINGUISHER - 45 & 60 LTR	24
POWDER FILLED MODULAR FIRE EXTINGUISHERS - 2,5,10 & 15 KG	25
CLEAN AGENT FILLED MODULAR FIRE EXTINGUISHER - 2,5,10 & 15 KG	26
CAFS - COMPRESSED AIR FOAM SYSTEM - 10 LTR	27
CAFS - COMPRESSED AIR FOAM SYSTEM - 50 LTR	28
BRACKETS	29

PART LIST FOR

1 & 2 KG POWDER STORED PRESSURE (MAP-50%, MAP-90% & MAP-90% UL LISTED) PORTABLE TYPE FIRE EXTINGUISHER

MODEL NOS.

KFARQ-1-50%
KFARQ-1-90%
KFAHQ-1-UL90%

KFARQ-2-50%
KFARQ-2-90%
KFAHQ-2-UL90%



Sr. No.	PART / ITEM CODE	DESCRIPTION
1	PCOATEDABODY-001	Powder coated body - 1KG
	PCOATEDABODY-002	Powder coated body - 2KG
2	FLRING-002	Fluorescent Plastic Ring ABC (Yellow)
	FLRING-003	Fluorescent Plastic Ring ABC (Black)
3	ALPIPE-108	Aluminum Syphon tube - 1KG
	ALPIPE-109	Aluminum Syphon tube - 2KG
	BSPIPE-101	Brass Syphon tube - 1KG
	BSPIPE-102	Brass Syphon tube - 2KG
	PSPIPE-101	Plastic Syphon tube - 1KG
	PSPIPE-102	Plastic Syphon tube - 2KG
4	AVLV-101	12 Series Valve Brass (Chrome Plated) 102 mm
	AVLV-107	Non-CE (Series 137) Brass (Chrome Plated) Small Handle-115 mm
	AVLV-103	CE (Series 137) Brass (Chrome Plated) Small Handle-115 mm
5	RM-300	Valve Spindle
6	RM-735	Valve Spring
7	RM-736	Syphon tube adaptor - PVC
	RM-550	Syphon tube adaptor - Aluminum
8	RM-248	O-Ring
9	PGAGE-101	Pressure gauge / Indicator
10	RM-384	Valve Safety pin
11	RM-012	Safety pin holder (String)
12	RM-039	Lever Lock
13	RM-268	Temper seal
14	NOZAL-015	PVC Discharge Nozzle
	NOZAL-001	Brass Discharge Nozzle
15	BASE-004	Bottom Base - 1KG
	BASE-005	Bottom Base - 2KG
16	LABLE-083	MAP-50% lable - 1KG
	LABLE-134	MAP-90% lable - 1KG
	LABLE-084	MAP-50% lable - 2KG
	LABLE-135	MAP-90% lable - 2KG
17	LABLE-088	Back side lable - RQ Series
	LABLE-157	Back side lable - HQ Series
18	POWDR-008	Mono Ammonium Phosphate based dry powder 50% (Confirms to IS:14609)
	POWDR-007	Mono Ammonium Phosphate based dry powder 90% (UL Listed)
	POWDR-017	Mono Ammonium Phosphate based dry powder 90%
19	WBRKT-012	Wall mounting Bracket for 1 kg with screw
	WBRKT-013	Wall mounting Bracket for 2 kg with screw
	Optional Brackets	For this Please check bracket page

NOTICE : The equipment/spares presented in this bulletin is to be installed/assembled in accordance with the latest publication standards of BIS or EN and CERTIFIED LABS wherever applicable. The information provided by us is to the best of our knowledge and belief, and consist of general guidelines only. Product development is a continuous programme of KANADIA FYR FYTER PVT LTD and hence the right to modify any specification without prior notice is reserved with the company.

KANEX®

KANADIA FYR FYTER PVT. LTD.

Office No.502, 5th Floor, A wing, Damji Shamji Corporate Square, Ghatkopar -Andheri Link Road, Laxmi Nagar, Ghatkopar (E) - 400 075

• Ph. No. : +91 22 67250731/32

• Website : www.kanexfire.com

• E-Mail : marketing@kanexfire.com

PART LIST FOR 4, 6 & 9 KG POWDER STORED PRESSURE (MAP-50%, MAP-90% & MAP-90% UL LISTED) PORTABLE TYPE FIRE EXTINGUISHER

MODEL Nos.

KFARQ-4-50%
KFARQ-4-90%
KFAHQ-4-UL90%

KFARQ-6-50%
KFARQ-6-90%
KFAHQ-6-UL90%

KFARQ-9-50%
KFARQ-9-90%
KFAHQ-9-UL90%



Sr. No.	PART / ITEM CODE	DESCRIPTION
1	PCOATEDABODY-3	Powder coated body - 4KG
	PCOATEDABODY-4	Powder coated body - 6KG
	PCOATEDABODY-5	Powder coated body - 9KG
2	FLRING-002	Fluorescent Plastic Ring ABC (Yellow)
	FLRING-003	Fluorescent Plastic Ring ABC (Black)
3	ALPIPE-122	Outer Aluminum Syphon tube - 4KG
	ALPIPE-123	Outer Aluminum Syphon tube - 6KG
	ALPIPE-121	Outer Aluminum Syphon tube - 9KG
	BSPICE-103	Outer Brass Syphon tube - 4KG
	BSPICE-104	Outer Brass Syphon tube - 6KG
	BSPICE-105	Outer Brass Syphon tube - 9KG
	PSPIPE-103	Outer Plastic Syphon tube - 4KG
	PSPIPE-104	Outer Plastic Syphon tube - 6KG
	PSPIPE-105	Outer Plastic Syphon tube - 9KG
4	AVLV-107	Non-CE (Series 137) Brass (Chrome Plated) Small Handle valve-115 mm
	AVLV-103	CE (Series 137) Brass (Chrome Plated) Small Handle valve-115 mm
	AVLV-104	CE (Series 137) Brass (Chrome Plated) Big Handle valve-140 mm
	AVLV-112	CE (Series 137) SS Small Handle valve-115 mm
	AVLV-111	CE (Series 137) SS Big Handle valve-140 mm
5	RM-300	Valve Spindle
6	RM-735	Valve Spring
7	RM-736	Syphon tube adaptor - PVC
7	RM-550	Syphon tube adaptor - Aluminum
8	RM-248	O-Ring
9	PGAGE-101	Pressure gauge / Indicator
10	RM-384	Valve Safety pin
11	RM-012	Safety pin holder (String)
12	RM-039	Lever Lock
13	RM-268	Temper seal
14	HOSE-001	EPDM Hose - 4 & 6 KG
	HOSE-057	PVC Braided hose - 4 & 6 KG
	HOSE-022	PARKER SAE-100-R6 Hose - 4 & 6 KG
	HOSE-002	EPDM Hose - 9KG
	HOSE-058	PVC Braided hose - 9 KG
	HOSE-023	PARKER SAE-100-R6 Hose - 9KG
15	NOZAL-002	Brass Nozzle - 4 & 6 KG
	NOZAL-013	PVC Nozzle - 4 & 6 KG
	NOZAL-003	Brass Nozzle - 9KG
	NOZAL-014	PVC Nozzle - 9KG
16	BASE-001	Bottom Base - 4KG
	BASE-002	Bottom Base - 6KG
	BASE-003	Bottom Base - 9KG
17	LABLE-085	MAP 50% LABLE - 4KG
	LABLE-086	MAP 50% LABLE - 6KG
	LABLE-087	MAP 50% LABLE - 9KG
	LABLE-136	MAP 90% LABLE - 4KG
	LABLE-137	MAP 90% LABLE - 6KG
	LABLE-138	MAP 90% LABLE - 9KG
18	LABLE-088	Back side lable - RQ Series
	LABLE-157	Back side lable - HQ Series
19	POWDR-008	MAP 50% Powder (Confirms to IS:14609)
	POWDR-007	MAP 90% Powder (UL Listed)
	POWDR-017	MAP 90% Powder (Confirms to IS:14609)
20	WBRKT-014	Wall mounting Bracket for 4 kg with screw
	WBRKT-015	Wall mounting Bracket for 6 kg with screw
	WBRKT-016	Wall mounting Bracket for 9 kg with screw
	Optional Brackets	For this Please check bracket page

NOTICE : The equipment/spares presented in this bulletin is to be installed/assembled in accordance with the latest publication standards of BIS or EN and CERTIFIED LABS wherever applicable. The information provided by us is to the best of our knowledge and belief, and consist of general guidelines only. Product development is a continuous programme of KANADIA FYR FYTER PVT LTD and hence the right to modify any specification without prior notice is reserved with the company.

KANEX®

KANADIA FYR FYTER PVT. LTD.

Office No.502, 5th Floor, A wing, Damji Shamji Corporate Square,
Ghatkopar -Andheri Link Road, Laxmi Nagar, Ghatkopar (E) - 400 075

• Ph. No. : +91 22 67250731/32

• Website : www.kanexfire.com

• E-Mail : marketing@kanexfire.com

PART LIST FOR

SS BODY 2 KG POWDER STORED PRESSURE (MAP-50%, MAP-90% & MAP-90% UL LISTED) PORTABLE TYPE FIRE EXTINGUISHER

MODEL NOs.

KFASSHQ-2-50%
KFASSHQ-2-90%
KFASSHQ-2-UL90%

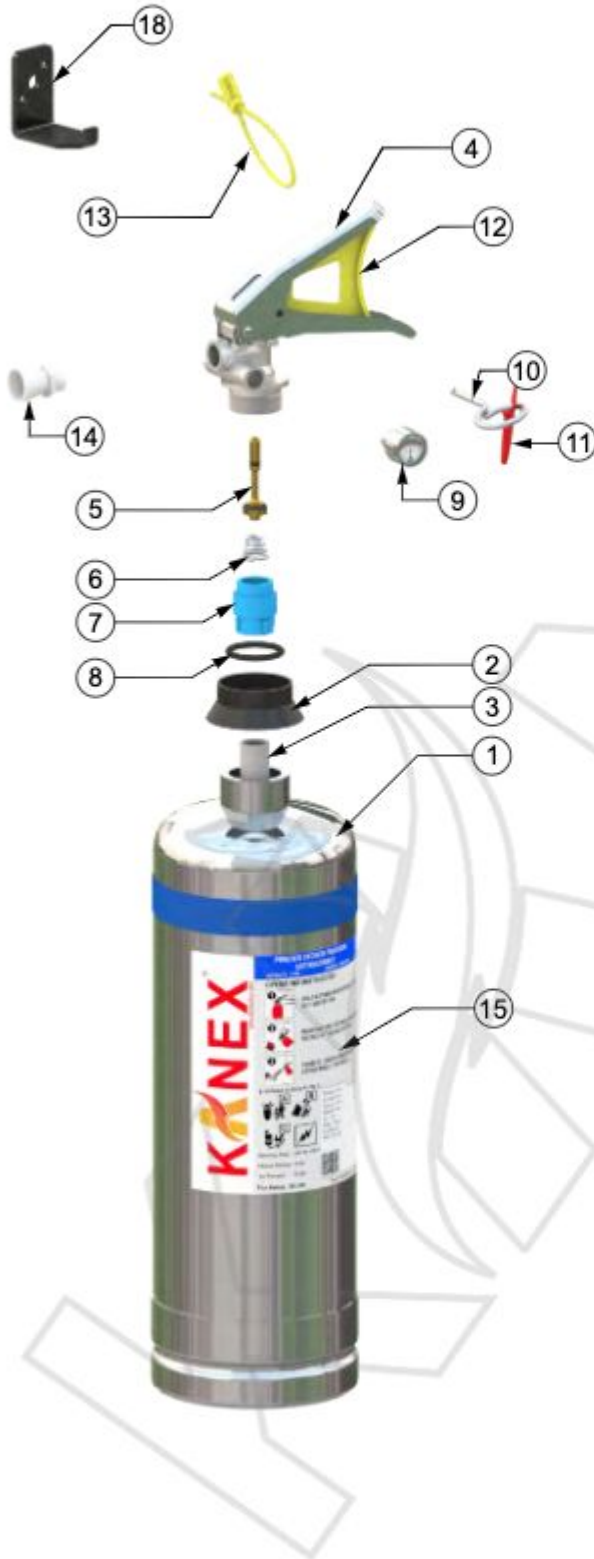

Sr. No.	PART / ITEM CODE	DESCRIPTION
1	ABCSSBODY-002	SS Body - 2KG
2	FLRING-002	Fluorescent Plastic Ring ABC (Yellow)
	FLRING-003	Fluorescent Plastic Ring ABC (Black)
3	ALPIPE-124	Aluminum Syphon tube - 2KG
4	AVLV-103	CE (Series 137) Brass (Chrome Plated) Small Handle valve-115 mm
	AVLV-112	CE (Series 137) Brass (Chrome Plated) SS Lever-Small Handle valve-115 mm
5	RM-300	Valve Spindle
6	RM-735	Valve Spring
7	RM-736	Syphon tube adaptor-PVC
	RM-550	Syphon tube adaptor-Aluminum
8	RM-248	O-Ring
9	PGAGE-101	Pressure gauge / Indicator
10	RM-384	Valve Safety pin
11	RM-012	Safety pin holder (String)
12	RM-039	Lever Lock
13	RM-268	Temper seal
14	NOZAL-001	Brass Nozzle - 2 KG
	NOZAL-015	PVC Nozzle - 2 KG
15	LABLE-167	Lable - 2KG
16	LABLE-182	Back side Lable
17	POWDR-008	MAP 50% Powder (Confirms to IS:14609)
	POWDR-017	MAP 90% Powder (Confirms to IS:14609)
	POWDR-021	MAP 90% Powder (UL Listed)
18	WBRKT-013	Wall mounting bracket for 2kg Fire extinguisher
	Optional Brackets	For this Please check bracket page

NOTICE : The equipment/spares presented in this bulletin is to be installed/assembled in accordance with the latest publication standards of BIS or EN and CERTIFIED LABS wherever applicable. The information provided by us is to the best of our knowledge and belief, and consist of general guidelines only. Product development is a continuous programme of KANADIA FYR FYTER PVT LTD and hence the right to modify any specification without prior notice is reserved with the company.

KANEX®

KANADIA FYR FYTER PVT. LTD.

Office No.502, 5th Floor, A wing,Damji Shamji Corporate Square,
Ghatkopar -Andheri Link Road,Laxmi Nagar,Ghatkopar (E) - 400 075

• Ph. No. : +91 22 67250731/32

• Website : www.kanexfire.com

• E-Mail : marketing@kanexfire.com

PART LIST FOR

SS BODY 4 & 6 KG POWDER STORED PRESSURE (MAP-50%, MAP-90% & MAP-90% UL LISTED) PORTABLE TYPE FIRE EXTINGUISHER

MODEL NOs.

KFASSHQ-4-50%
KFASSHQ-6-50%

KFASSHQ-4-90%
KFASSHQ-6-90%

KFASSHQ-4-UL90%
KFASSHQ-6-UL90%



Sr. No.	PART / ITEM CODE	DESCRIPTION
1	ABCSSBODY-003	SS Body - 4KG
	ABCSSBODY-004	SS Body - 6KG
2	FLRING-002	Fluorescent Plastic Ring ABC (Yellow)
	FLRING-003	Fluorescent Plastic Ring ABC (Black)
3	ALPIPE-122	Aluminum Syphon tube - 4KG
	ALPIPE-123	Aluminum Syphon tube - 6KG
4	AVLV-103	CE (Series 137) Brass (Chrome Plated) Small Handle valve-115 mm
	AVLV-112	CE (Series 137) Brass (Chrome Plated) SS Lever-Small Handle valve-115 mm
5	RM-300	Valve Spindle
6	RM-735	Valve Spring
7	RM-736	Syphon tube adaptor-PVC
	RM-550	Syphon tube adaptor-Aluminum
8	RM-248	O-Ring
9	PGAGE-101	Pressure gauge / Indicator
10	RM-384	Valve Safety pin
11	RM-012	Safety pin holder (String)
12	RM-039	Lever Lock
13	RM-268	Temper seal
14	HOSE-001	EPDM Hose - 4 & 6 KG
	HOSE-022	PARKER Hose - 4 & 6 KG
15	NOZAL-002	Brass Nozzle - 4 & 6 KG
	NOZAL-013	PVC Nozzle - 4 & 6 KG
16	BELT-004	Lock type belt - 4KG
	BELT-006	Lock type belt - 6KG
	BELT-010	Pull type Belt - 4 KG
	BELT-011	Pull type Belt - 6 KG
17	LABLE-168	Lable - 4KG
	LABLE-169	Lable - 6KG
18	LABLE-182	Back side Lable
19	POWDR-008	MAP 50% Powder (Confirms to IS:14609)
	POWDR-017	MAP 90% Powder (Confirms to IS:14609)
	POWDR-021	MAP 90% Powder (UL Listed)
20	WBRKT-014	Wall mounting Bracket for 4 kg with screw
	WBRKT-015	Wall mounting Bracket for 6 kg with screw
	Optional Brackets	For this Please check bracket page

NOTICE : The equipment/spares presented in this bulletin is to be installed/assembled in accordance with the latest publication standards of BIS or EN and CERTIFIED LABS wherever applicable. The information provided by us is to the best of our knowledge and belief, and consist of general guidelines only. Product development is a continuous programme of KANADIA FYR FYTER PVT LTD and hence the right to modify any specification without prior notice is reserved with the company.

KANEX®

KANADIA FYR FYTER PVT. LTD.

Office No.502, 5th Floor, A wing,Damji Shamji Corporate Square,
Ghatkopar -Andheri Link Road,Laxmi Nagar,Ghatkopar (E) - 400 075

• Ph. No. : +91 22 67250731/32

• Website : www.kanexfire.com

• E-Mail : marketing@kanexfire.com

PART LIST FOR

4, 6 & 9 KG POWDER CARTRIDGE PRESSURE (SBC, PBC, MAP-50%, MAP-90% & MAP-90% UL LISTED) PORTABLE TYPE FIRE EXTINGUISHER

MODEL NOs.

KFDRQ-4-S
KFDRQ-4-P
KFDRQ-4-50%
KFDRQ-4-90%
KFDHQ-4-UL90%

KFDRQ-6-S
KFDRQ-6-P
KFDRQ-6-50%
KFDRQ-6-90%
KFDHQ-6-UL90%

KFDRQ-9-S
KFDRQ-9-P
KFDRQ-9-50%
KFDRQ-9-90%
KFDHQ-9-UL90%



Sr. No.	PART / ITEM CODE	DESCRIPTION
1	PCOATEDDBODY-1	Powder coated body - 4KG
	PCOATEDDBODY-2	Powder coated body - 6KG
	PCOATEDDBODY-3	Powder coated body - 9KG
2	ALPIPE-122	Outer Aluminum Syphon tube - 4KG
	ALPIPE-123	Outer Aluminum Syphon tube - 6KG
	ALPIPE-121	Outer Aluminum Syphon tube - 9KG
	BSPIPE-103	Outer Brass Syphon tube - 4KG
	BSPIPE-104	Outer Brass Syphon tube - 6KG
	BSPIPE-105	Outer Brass Syphon tube - 9KG
	PSPPIPE-103	Outer Plastic Syphon tube - 4KG
	PSPPIPE-104	Outer Plastic Syphon tube - 6KG
	PSPPIPE-105	Outer Plastic Syphon tube - 9KG
3	ALPIPE-115	Inner Aluminum syphon tube - 4KG
	BSPIPE-115	Inner Brass syphon tube - 4KG
	ALPIPE-116	Inner Aluminum syphon tube - 6KG
	BSPIPE-116	Inner Brass syphon tube - 6KG
	ALPIPE-117	Inner Aluminum syphon tube - 9KG
4	DVLV-101	Series 193 Brass (Chrome Plated) Valve
	DVLV-103	Series 193 Brass (Chrome Plated) SS handle Valve
5	RM-500	Valve Safety pin for DCP
6	RM-012	Safety pin holder (String)
7	RM-039	Lever Lock
8	RM-268	Temper seal
9	KCR-120	120gm Cartridge - 4 & 6 KG
	KCR-200	200GM Cartridge - 9 KG
10	HOSE-001	EPDM Hose - 4 & 6 KG
	HOSE-057	PVC Braided hose - 4 & 6 KG
	HOSE-022	PARKER SAE-100-R6 Hose - 4 & 6 KG
	HOSE-002	EPDM Hose - 9KG
	HOSE-058	PVC Braided hose - 9 KG
	HOSE-023	PARKER SAE-100-R6 Hose - 9KG
11	NOZAL-002	Brass Nozzle - 4 & 6 KG
	NOZAL-013	PVC Nozzle - 4 & 6 KG
	NOZAL-003	Brass Nozzle - 9KG
	NOZAL-014	PVC Nozzle - 9KG
12	BASE-001	Bottom Base - 4KG
	BASE-002	Bottom Base - 6KG
	BASE-003	Bottom Base - 9KG
13	LABLE-098	BC Powder - 4KG
	LABLE-128	BC Powder - 6KG
	LABLE-129	BC Powder - 9KG
	LABLE-139	MAP Powder LABLE - 4KG
	LABLE-140	MAP Powder LABLE - 6KG
14	LABLE-141	MAP Powder LABLE - 9KG
	LABLE-099	Back side lable
	POWDR-011	SBC Powder (Confirms to IS:4308)
	POWDR-015	PBC Powder (Confirms to IS:4308)
15	POWDR-008	MAP 50% Powder (Confirms to IS:14609)
	POWDR-007	MAP 90% Powder (UL Listed)
	POWDR-017	MAP 90% Powder (Confirms to IS:14609)
	POWDR-017	MAP 90% Powder (Confirms to IS:14609)
16	JBRKT-001	J-Bracket for Cartridge type Fire extinguisher
	Optional Brackets	For this Please check bracket page

NOTICE : The equipment/spares presented in this bulletin is to be installed/assembled in accordance with the latest publication standards of BIS or EN and CERTIFIED LABS wherever applicable. The information provided by us is to the best of our knowledge and belief, and consist of general guidelines only. Product development is a continuous programme of KANADIA FYR FYTER PVT LTD and hence the right to modify any specification without prior notice is reserved with the company.

KANEX®

KANADIA FYR FYTER PVT. LTD.

Office No.502, 5th Floor, A wing, Damji Shamji Corporate Square,
Ghatkopar -Andheri Link Road, Laxmi Nagar, Ghatkopar (E) - 400 075

• Ph. No. : +91 22 67250731/32

• Website : www.kanexfire.com

• E-Mail : marketing@kanexfire.com

PART LIST FOR

2 KG CLEAN AGENT STORED PRESSURE (HFC 236fa & FE 36) PORTABLE TYPE FIRE EXTINGUISHER

MODEL NOs.

KCARQ-2
KCAHQ-2-FE36

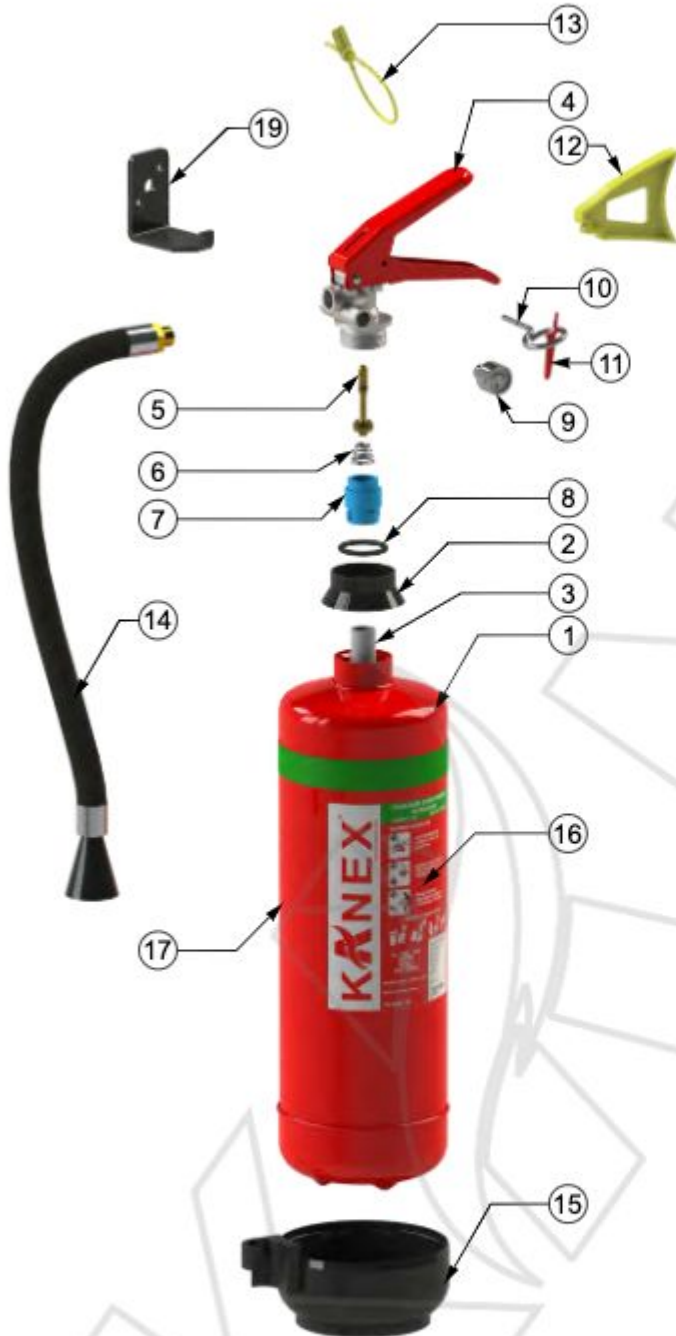

Sr. No.	PART / ITEM CODE	DESCRIPTION
1	PCOATEDCLBODY-002	Powder coated body
2	FLRING-002	Fluorescent Plastic Ring ABC (Yellow)
	FLRING-003	Fluorescent Plastic Ring ABC (Black)
3	ALPIPE-124	Aluminum Syphon tube
4	AVLV-107	Non-CE (Series 137) Brass (Chrome Plated) Small Handle-115 mm
	AVLV-103	CE (Series 137) Brass (Chrome Plated) Small Handle-115 mm
5	RM-300	Valve Spindle
6	RM-735	Valve Spring
7	RM-736	Syphon tube adaptor - PVC
	RM-550	Syphon tube adaptor - Aluminum
8	RM-248	O-Ring
9	PGAGE-102	Pressure gauge / Indicator
10	RM-384	Valve Safety pin
11	RM-012	Safety pin holder (String)
12	RM-039	Lever Lock
13	RM-268	Temper seal
14	AHOSE-001	Hose with Nozzle
15	BASE-005	Bottom Base - 2KG
16	LABLE-108	Transparent lable - Front
17	LABLE-110	Backside Lable
18	GAS-005	FE 36 clean agent
	GAS-006	Clean Agent HFC 236fa
19	WBRKT-013	Wall mounting Bracket with screw
	Optional Brackets	For this Please check bracket page

NOTICE : The equipment/spares presented in this bulletin is to be installed/assembled in accordance with the latest publication standards of BIS or EN and CERTIFIED LABS wherever applicable. The information provided by us is to the best of our knowledge and belief, and consist of general guidelines only. Product development is a continuous programme of KANADIA FYR FYTER PVT LTD and hence the right to modify any specification without prior notice is reserved with the company.

KANEX[®]

KANADIA FYR FYTER PVT. LTD.

Office No.502, 5th Floor, A wing,Damji Shamji Corporate Square, Ghatkopar -Andheri Link Road,Laxmi Nagar,Ghatkopar (E) - 400 075

• Ph. No. : +91 22 67250731/32

• Website : www.kanexfire.com• E-Mail : marketing@kanexfire.com

PART LIST FOR

4 & 6 KG CLEAN AGENT STORED PRESSURE (HFC 236fa & CHEMOURS FE36) PORTABLE TYPE FIRE EXTINGUISHER

MODEL NOs.

KCARQ-4
KCARQ-6

KCAHQ-4-FE36
KCAHQ-6-FE36



Sr. No.	PART / ITEM CODE	DESCRIPTION
1	PCOATEDCLBODY-003	Powder coated body - 4KG
	PCOATEDCLBODY-004	Powder coated body - 6KG
2	FLRING-002	Fluorescent Plastic Ring ABC (Yellow)
	FLRING-003	Fluorescent Plastic Ring ABC (Black)
3	ALPIPE-122	Aluminum Syphon tube - 4KG
	ALPIPE-123	Aluminum Syphon tube - 6KG
	BSPIPE-103	Brass Syphon tube - 4KG
	BSPIPE-104	Brass Syphon tube - 6KG
	PSPIPE-103	Plastic Syphon tube - 4KG
	PSPIPE-104	Plastic Syphon tube - 6KG
4	AVLV-101	12 Serie Valve
	AVLV-107	Non-CE (Series 137) Brass (Chrome Plated) Small Handle valve-115 mm
	AVLV-103	CE (Series 137) Brass (Chrome Plated) Small Handle valve-115 mm
	AVLV-112	CE (Series 137) Brass (Chrome Plated) with SS Lever
5	RM-300	Valve Spindle
6	RM-735	Valve Spring
7	RM-736	Syphon tube adaptor - PVC
	RM-550	Syphon tube adaptor - Aluminum
8	RM-248	O-Ring
9	PGAGE-102	Pressure gauge / Indicator
10	RM-384	Valve Safety pin
11	RM-012	Safety pin holder (String)
12	RM-039	Lever Lock
13	RM-268	Temper seal
14	ASHOSE-002	Hose with Nozzle - 4 & 6KG
15	BASE-001	Bottom Base - 4KG
	BASE-002	Bottom Base - 6KG
16	LABLE-109	Transparent Label - 4KG
	LABLE-111	Transparent Label - 6KG
17	LABLE-110	Back side lable - 4KG
	LABLE-112	Back side lable - 6KG
18	GAS-005	Clean Agent FE36 gas
	GAS-006	Clean Agent HFC 236fa
19	WBRKT-014	Wall mounting Bracket for 4 kg with screw
	WBRKT-015	Wall mounting Bracket for 6 kg with screw
	Optional Brackets	For this Please check bracket page

NOTICE : The equipment/spares presented in this bulletin is to be installed/assembled in accordance with the latest publication standards of BIS or EN and CERTIFIED LABS wherever applicable. The information provided by us is to the best of our knowledge and belief, and consist of general guidelines only. Product development is a continuous programme of KANADIA FYR FYTER PVT LTD and hence the right to modify any specification without prior notice is reserved with the company.

KANEX®

KANADIA FYR FYTER PVT. LTD.

Office No.502, 5th Floor, A wing,Damji Shamji Corporate Square,
Ghatkopar -Andheri Link Road,Laxmi Nagar,Ghatkopar (E) - 400 075

• Ph. No. : +91 22 67250731/32

• Website : www.kanexfire.com

• E-Mail : marketing@kanexfire.com

PART LIST FOR

SS BODY 2, 4 & 6 KG CLEAN AGENT STORED PRESSURE (CHEMOURS FE 36) PORTABLE TYPE FIRE EXTINGUISHER

MODEL NOs.

KCASSHQ-2-FE36

KCASSHQ-4-FE36

KCASSHQ-6-FE36

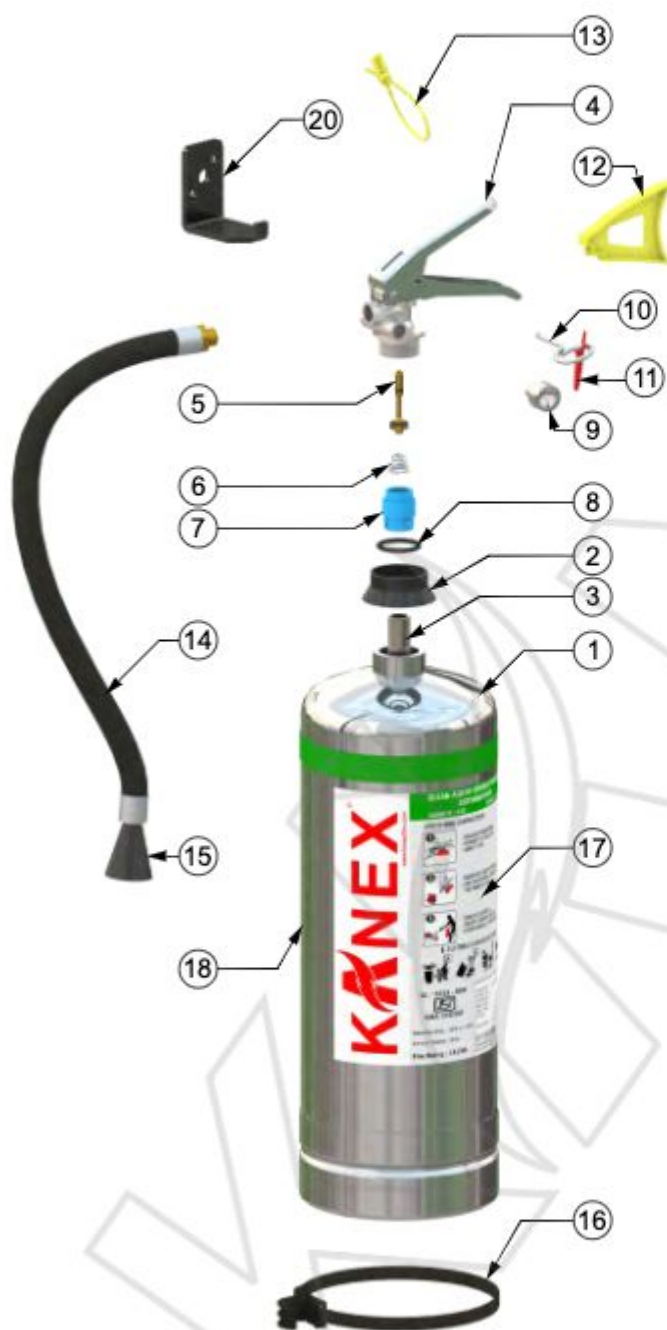

Sr. No.	PART / ITEM CODE	DESCRIPTION
1	ABCSSBODY-002	SS Body - 2KG
	ABCSSBODY-003	SS Body - 4KG
	ABCSSBODY-004	SS Body - 6KG
2	FLRING-002	Fluorescent Plastic Ring ABC (Yellow)
	FLRING-003	Fluorescent Plastic Ring ABC (Black)
3	ALPIPE-124	Aluminum Syphon tube - 2KG
	ALPIPE-122	Aluminum Syphon tube - 4KG
	ALPIPE-123	Aluminum Syphon tube - 6KG
4	AVLV-103	CE (Series 137) Brass (Chrome Plated) Small Handle valve-115 mm
	AVLV-112	CE (Series 137) Brass (Chrome Plated) SS Lever Small Handle valve-115 mm
5	RM-300	Valve Spindle
6	RM-735	Valve Spring
7	RM-736	Syphon tube adaptor - PVC
	RM-550	Syphon tube adaptor - Aluminum
8	RM-248	O-Ring
9	PGAGE-102	Pressure gauge / Indicator
10	RM-384	Valve Safety pin
11	RM-012	Safety pin holder (String)
12	RM-039	Lever Lock
13	RM-268	Temper seal
14	HOSE-004	EPDM Hose - 2 KG
	HOSE-081	EPDM Hose - 2 KG (One side no connection)
	HOSE-006	EPDM Hose - 4 & 6 KG
	HOSE-070	EPDM Hose - 4 & 6 KG (One side no connection)
15	NOZAL-004	Aluminum nozzle
16	BELT-004	Lock type belt - 2 & 4KG
	BELT-005	Lock type belt - 6KG
	BELT-012	Pull type Belt - 2 KG
	BELT-010	Pull type Belt - 4 KG
	BELT-011	Pull type Belt - 6 KG
17	LABLE-172	Lable - 2KG
	LABLE-173	Lable - 4KG
	LABLE-174	Lable - 6KG
18	LABLE-010	Back side lable - 2 & 4 KG
	LABLE-012	Back side lable - 6 KG
19	GAS-005	FE 36 clean agent
20	WBRKT-013	Wall mounting Bracket for 2KG with screw
	WBRKT-014	Wall mounting Bracket for 4KG with screw
	WBRKT-015	Wall mounting Bracket for 6KG with screw
	Optional Brackets	For this Please check bracket page

NOTICE : The equipment/spares presented in this bulletin is to be installed/assembled in accordance with the latest publication standards of BIS or EN and CERTIFIED LABS wherever applicable. The information provided by us is to the best of our knowledge and belief, and consist of general guidelines only. Product development is a continuous programme of KANADIA FYR FYTER PVT LTD and hence the right to modify any specification without prior notice is reserved with the company.

KANEX®

KANADIA FYR FYTER PVT. LTD.

Office No.502, 5th Floor, A wing, Damji Shamji Corporate Square, Ghatkopar -Andheri Link Road, Laxmi Nagar, Ghatkopar (E) - 400 075

• Ph. No. : +91 22 67250731/32

• Website : www.kanexfire.com• E-Mail : marketing@kanexfire.com

PART LIST FOR

6 & 9 LTR MECHANICAL FOAM STORED PRESSURE (AFFF + WATER) OR (AR-AFFF + WATER) PORTABLE TYPE FIRE EXTINGUISHER

MODEL NOs.

KFMSRQ-6
KFMSRQ-9

KFMESHQ-6-AR
KFMESHQ-9-AR



Sr. No.	PART / ITEM CODE	DESCRIPTION
1	PCOATEDMWBODY-001	Powder coated body - 9LTR
	PCOATEDMWBODY-003	Powder coated body - 6LTR
2	FLRING-002	Fluorescent Plastic Ring ABC (Yellow)
	FLRING-003	Fluorescent Plastic Ring ABC (Black)
3	ALPIPE-121	Aluminum Syphon tube - 9LTR
	PSPPIPE-106	PVC syphon with filter
4	AVLV-107	Non-CE (Series 137) Brass (Chrome Plated) Small Handle valve-115 mm
	AVLV-103	CE (Series 137) Brass (Chrome Plated) Small Handle valve-115 mm
	AVLV-104	CE (Series 137) Brass (Chrome Plated) Big Handle valve-140 mm
	AVLV-112	CE (Series 137) SS Small Handle valve-115 mm
	AVLV-111	CE (Series 137) SS Big Handle valve-140 mm
5	RM-300	Valve Spindle
6	RM-735	Valve Spring
7	RM-736	Syphon tube adaptor - PVC
	RM-550	Syphon tube adaptor - Aluminum
8	RM-248	O-Ring
9	PGAGE-101	Pressure gauge / Indicator
10	RM-384	Valve Safety pin
11	RM-012	Safety pin holder (String)
12	RM-039	Lever Lock
13	RM-268	Temper seal
14	HOSE-003	EPDM Hose
15	NOZAL-005	PVC Nozzle
	NOZAL-007	Aluminum Nozzle
16	BASE-003	Bottom Base
17	LABLE-100	Transparent lable - 9Ltr
	LABLE-184	Transparent lable - 6Ltr
18	LABLE-101	Back side Lable - 9Ltr
	LABLE-185	Back side Lable - 6Ltr
19	MRIFIL-001	Mfoam refill 3%
	MRIFIL-005	Mfoam Refill 6%
	MRIFIL-010	Mfoam Refill AR-AFFF 3x3%
20	WBRKT-015	Wall mounting Bracket for 6 Ltr with screw
	WBRKT-016	Wall mounting Bracket for 9 Ltr with screw
	Optional Brackets	For this Please check bracket page

NOTICE : The equipment/spares presented in this bulletin is to be installed/assembled in accordance with the latest publication standards of BIS or EN and CERTIFIED LABS wherever applicable. The information provided by us is to the best of our knowledge and belief, and consist of general guidelines only. Product development is a continuous programme of KANADIA FYR FYTER PVT LTD and hence the right to modify any specification without prior notice is reserved with the company.

KANEX®

KANADIA FYR FYTER PVT. LTD.

Office No.502, 5th Floor, A wing, Damji Shamji Corporate Square,
Ghatkopar -Andheri Link Road, Laxmi Nagar, Ghatkopar (E) - 400 075

• Ph. No. : +91 22 67250731/32

• Website : www.kanexfire.com

• E-Mail : marketing@kanexfire.com

PART LIST FOR

6 & 9 LTR SS BODY MECHANICAL FOAM STORED PRESSURE (AR-AFFF + WATER) PORTABLE TYPE FIRE EXTINGUISHER

MODEL NOs.

KFMSSHQ-6-AR
KFMSSHQ-9-AR



Sr. No.	PART / ITEM CODE	DESCRIPTION
1	ABCSSBODY-004	SS body - 6 Ltr
	ABCSSBODY-005	SS body - 9 Ltr
2	FLRING-002	Fluorescent Plastic Ring ABC (Yellow)
	FLRING-003	Fluorescent Plastic Ring ABC (Black)
3	PSPIPE-106	PVC syphon with filter
	ALPIPE-123	Aluminum Syphon tube - 6LTR
	ALPIPE-121	Aluminum Syphon tube - 9LTR
4	AVLV-112	CE (Series 137) SS Small Handle valve-115 mm
	AVLV-111	CE (Series 137) SS Big Handle valve-140 mm
5	RM-300	Valve Spindle
6	RM-735	Valve Spring
7	RM-736	Syphon tube adaptor - PVC
	RM-550	Syphon tube adaptor - Aluminum
8	RM-248	O-Ring
9	PGAGE-101	Pressure gauge / Indicator
10	RM-384	Valve Safety pin
11	RM-012	Safety pin holder (String)
12	RM-039	Lever Lock
13	RM-268	Temper seal
14	HOSE-003	EPDM discharge Hose
15	NOZAL-005	PVC Nozzle
16	NOZAL-007	Aluminum Nozzle
17	BELT-011	Pull type Belt
18	LABLE	Transparent lable - 9Ltr
	LABLE	Transparent lable - 6Ltr
19	LABLE	Back side Lable - 9Ltr
	LABLE	Back side Lable - 6Ltr
20	MRIFIL-010	Mfoam Refill AR-AFFF 3x3%
	WBRKT-015	Wall mounting Bracket for 6 Ltr with screw
	WBRKT-016	Wall mounting Bracket for 9 Ltr with screw
	Optional Brackets	For this Please check bracket page

NOTICE : The equipment/spares presented in this bulletin is to be installed/assembled in accordance with the latest publication standards of BIS or EN and CERTIFIED LABS wherever applicable. The information provided by us is to the best of our knowledge and belief, and consist of general guidelines only. Product development is a continuous programme of KANADIA FYR FYTER PVT LTD and hence the right to modify any specification without prior notice is reserved with the company.

KANEX®

KANADIA FYR FYTER PVT. LTD.

Office No.502, 5th Floor, A wing,Damji Shamji Corporate Square, Ghatkopar -Andheri Link Road,Laxmi Nagar,Ghatkopar (E) - 400 075

• Ph. No. : +91 22 67250731/32

• Website : www.kanexfire.com• E-Mail : marketing@kanexfire.com

PART LIST FOR

6 & 9 LTR MECHANICAL FOAM CARTRIDGE PRESSURE (AFFF + WATER) OR (AR-AFFF + WATER) PORTABLE TYPE FIRE EXTINGUISHER

MODEL NOs.

KFMCQR-6
KFMCQR-9

KFMCHQ-6-AR
KFMCHQ-9-AR



Sr. No.	PART / ITEM CODE	DESCRIPTION
1	PCOATEDMWBODY-002	Powder coated body - 9LTR
	PCOATEDMWBODY-004	Powder coated body - 6LTR
2	ALPIPE-123	Aluminum Syphon tube - 6LTR
	ALPIPE-121	Aluminum Syphon tube - 9LTR
	BSPICE-104	Brass syphon tube - 6LTR
	BSPICE-105	Brass syphon tube - 9LTR
	PSPICE-104	PVC Syphon tube - 6LTR
	PSPICE-106	PVC syphon with filter - 9LTR
3	DVLV-101	Series 193 Brass (Chrome Plated) Valve
	DVLV-103	Series 193 Brass (Chrome Plated) SS handle Valve
4	RM-500	Valve Safety pin for DCP
5	RM-012	Safety pin holder (String)
6	RM-039	Lever Lock
7	RM-268	Temper seal
8	KCR-60	60gm Cartridge
9	HOSE-003	EPDM Hose - 6 & 9 LTR
10	NOZAL-005	PVC Nozzle
	NOZAL-007	Aluminum nozzle
11	BASE-002	Bottom Base - 6LTR
	BASE-003	Bottom Base - 9LTR
12	LABLE-104	Transparent Label - 9Ltr
	LABLE-188	Transparent Label - 6Ltr
13	LABLE-105	Backside Lable - 9Ltr
	LABLE-189	Backside Lable - 6Ltr
	MRIFIL-001	Mfoam refill 3%
14	MRIFIL-005	Mfoam Refill 6%
	MRIFIL-010	Mfoam Refill AR-AFFF 3x3%
15	JBRKT-001	J-Bracket for Cartridge type Fire extinguisher
	Optional Brackets	For this Please check bracket page

NOTICE : The equipment/spares presented in this bulletin is to be installed/assembled in accordance with the latest publication standards of BIS or EN and CERTIFIED LABS wherever applicable. The information provided by us is to the best of our knowledge and belief, and consist of general guidelines only. Product development is a continuous programme of KANADIA FYR FYTER PVT LTD and hence the right to modify any specification without prior notice is reserved with the company.

KANEX®

KANADIA FYR FYTER PVT. LTD.

Office No.502, 5th Floor, A wing, Damji Shamji Corporate Square, Ghatkopar -Andheri Link Road, Laxmi Nagar, Ghatkopar (E) - 400 075

• Ph. No. : +91 22 67250731/32

• Website : www.kanexfire.com

• E-Mail : marketing@kanexfire.com

PART LIST FOR

6 & 9 LTR WATER STORED PRESSURE (DE-MINERALISED WATER) PORTABLE TYPE FIRE EXTINGUISHER

MODEL NOs.

KFWSRQ-6
KFWSRQ-9

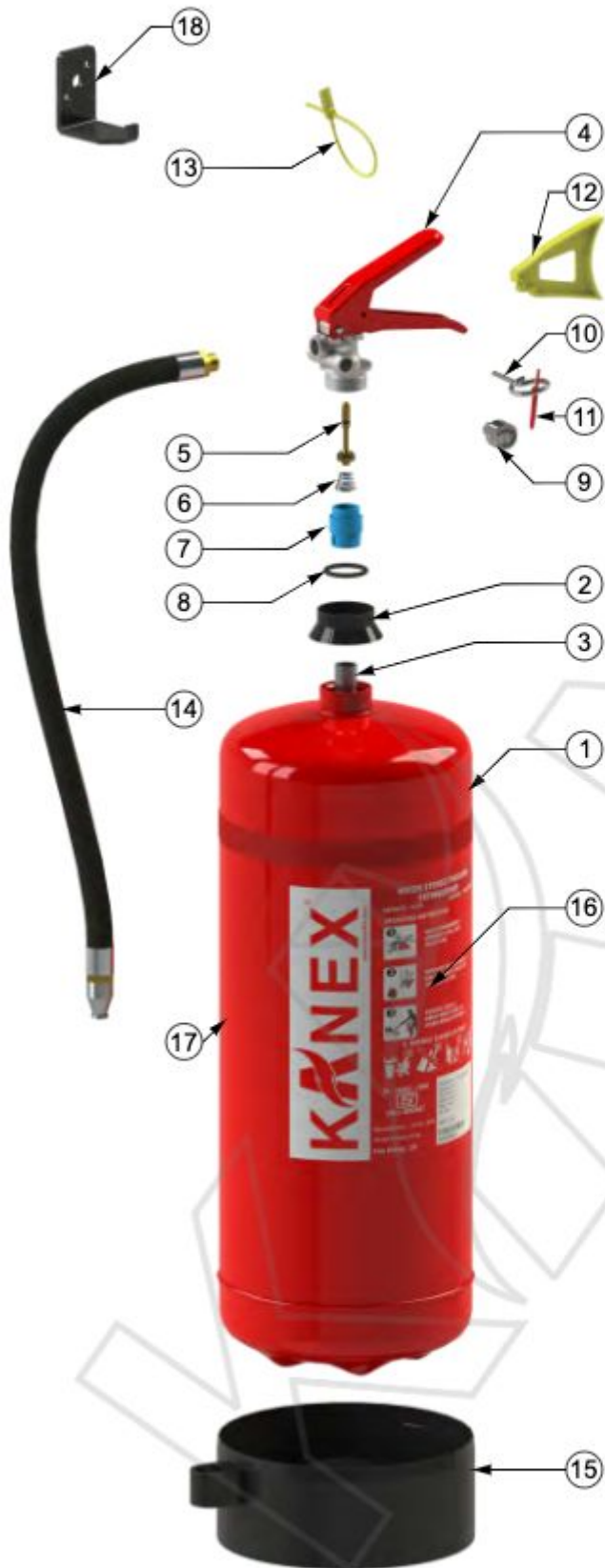

Sr. No.	PART / ITEM CODE	DESCRIPTION
1	PCOATEDMWBODY-001	Powder coated body - 9LTR
	PCOATEDMWBODY-003	Powder coated body - 6LTR
2	FLRING-002	Fluorescent Plastic Ring ABC (Yellow)
	FLRING-003	Fluorescent Plastic Ring ABC (Black)
3	ALPIPE-123	Aluminum Syphon tube - 6LTR
	ALPIPE-121	Aluminum Syphon tube - 9LTR
	BSPIPE-104	Brass Syphon tube - 6LTR
	BSPIPE-105	Brass Syphon tube - 9LTR
	PSPIPE-104	PVC Syphon tube - 6LTR
	PSPIPE-106	PVC syphon with filter - 9LTR
4	AVLV-107	Non-CE (Series 137) Brass (Chrome Plated) Small Handle valve-115 mm
	AVLV-103	CE (Series 137) Brass (Chrome Plated) Small Handle valve-115 mm
	AVLV-104	CE (Series 137) Brass (Chrome Plated) Big Handle valve-140 mm
	AVLV-112	CE (Series 137) SS Small Handle valve-115 mm
	AVLV-111	CE (Series 137) SS Big Handle valve-140 mm
5	RM-300	Valve Spindle
6	RM-535	Valve Spring
7	RM-539	Syphon tube adaptor
	RM-550	Syphon tube adaptor - Aluminum
8	RM-248	O-Ring
9	PGAGE-101	Pressure gauge / Indicator
10	RM-384	Valve Safety pin
11	RM-012	Safety pin holder (String)
12	RM-039	Lever Lock
13	RM-268	Temper seal
14	HOSE-005	EPDM Hose
	BASE-002	Bottom Base - 6LTR
15	BASE-003	Bottom Base - 9LTR
	LABLE-102	Transparent lable - 9LTR
16	LABLE-186	Transparent lable - 6LTR
	LABLE-103	Backside lable - 9LTR
17	LABLE-187	Backside lable - 6LTR
	WBRKT-015	Wall mounting Bracket for 6 Ltr with screw
18	WBRKT-016	Wall mounting Bracket for 9 Ltr with screw
	Optional Brackets	For this Please check bracket page

NOTICE : The equipment/spares presented in this bulletin is to be installed/assembled in accordance with the latest publication standards of BIS or EN and CERTIFIED LABS wherever applicable. The information provided by us is to the best of our knowledge and belief, and consist of general guidelines only. Product development is a continuous programme of KANADIA FYR FYTER PVT LTD and hence the right to modify any specification without prior notice is reserved with the company.

KANEX®

KANADIA FYR FYTER PVT. LTD.

Office No.502, 5th Floor, A wing, Damji Shamji Corporate Square, Ghatkopar -Andheri Link Road, Laxmi Nagar, Ghatkopar (E) - 400 075

• Ph. No. : +91 22 67250731/32

• Website : www.kanexfire.com• E-Mail : marketing@kanexfire.com

PART LIST FOR

6 & 9 LTR SS BODY WATER STORED PRESSURE (DE-MINERALISED WATER) PORTABLE TYPE FIRE EXTINGUISHER

MODEL NOs.

KFWSSHQ-6
KFWSSHQ-9

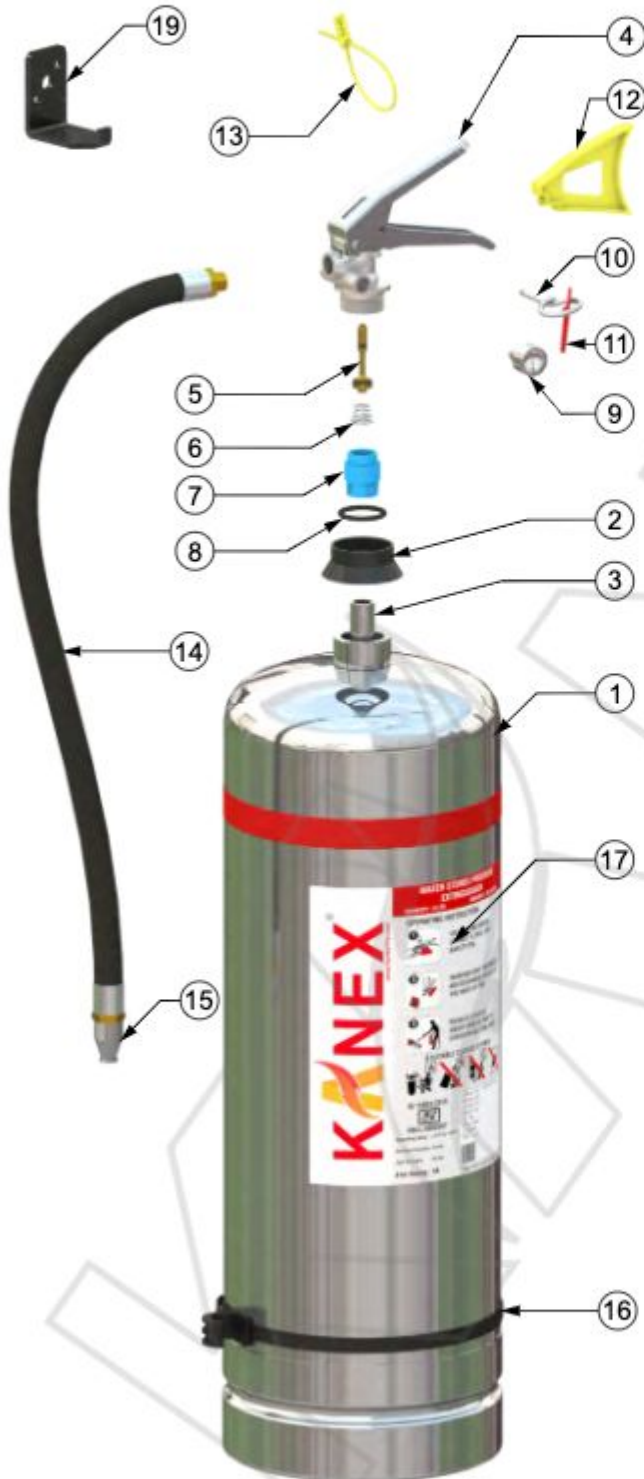

Sr. No.	PART / ITEM CODE	DESCRIPTION
1	ABCSSBODY-004	SS body - 6 Ltr
	ABCSSBODY-005	SS body - 9 Ltr
2	FLRING-002	Fluorescent Plastic Ring ABC (Yellow)
	FLRING-003	Fluorescent Plastic Ring ABC (Black)
3	PSPIPE-106	PVC syphon with filter
	ALPIPE-123	Aluminum Syphon tube - 6LTR
	ALPIPE-121	Aluminum Syphon tube - 9LTR
4	AVLV-112	CE (Series 137) SS Small Handle valve-115 mm
	AVLV-111	CE (Series 137) SS Big Handle valve-140 mm
5	RM-300	Valve Spindle
6	RM-535	Valve Spring
7	RM-539	Syphon tube adaptor
	RM-550	Syphon tube adaptor - Aluminum
8	RM-248	O-Ring
9	PGAGE-101	Pressure gauge / Indicator
10	RM-384	Valve Safety pin
11	RM-012	Safety pin holder (String)
12	RM-039	Lever Lock
13	RM-268	Temper seal
14	HOSE-005	EPDM Hose With aluminum nozzle
15	NOZAL-023	Brass Nozzle - in option with Aluminum nozzle
16	BELT-011	Pull type Belt 6 & 9 LTR
17	LABLE	Transparent lable - 6LTR
	LABLE	Transparent lable - 9LTR
	LABLE	Backside lable - 6LTR
	LABLE	Backside lable - 9LTR
18	WBRKT-015	Wall mounting Bracket for 6 Ltr with screw
	WBRKT-016	Wall mounting Bracket for 9 Ltr with screw
19	Optional Brackets	For this Please check bracket page

NOTICE : The equipment/spares presented in this bulletin is to be installed/assembled in accordance with the latest publication standards of BIS or EN and CERTIFIED LABS wherever applicable. The information provided by us is to the best of our knowledge and belief, and consist of general guidelines only. Product development is a continuous programme of KANADIA FYR FYTER PVT LTD and hence the right to modify any specification without prior notice is reserved with the company.

KANEX®

KANADIA FYR FYTER PVT. LTD.

Office No.502, 5th Floor, A wing, Damji Shamji Corporate Square, Ghatkopar -Andheri Link Road, Laxmi Nagar, Ghatkopar (E) - 400 075

• Ph. No. : +91 22 67250731/32

• Website : www.kanexfire.com• E-Mail : marketing@kanexfire.com

PART LIST FOR

6 & 9 LTR WATER CARTRIDGE PRESSURE (DE-MINERALISED WATER) PORTABLE TYPE FIRE EXTINGUISHER

MODEL NOs.

KFWCRQ-6
KFWCRQ-9



Sr. No.	PART / ITEM CODE	DESCRIPTION
1	PCOATEDMWBODY-002	Powder coated body - 9LTR
	PCOATEDMWBODY-004	Powder coated body - 6LTR
2	ALPIPE-123	Aluminum Syphon tube - 6LTR
	ALPIPE-121	Aluminum Syphon tube - 9LTR
	BSPIPE-104	Brass syphon tube - 6LTR
	BSPIPE-105	Brass syphon tube - 9LTR
	PSPIPE-104	PVC Syphon tube - 6LTR
	PSPIPE-106	PVC Syphon tube - 9LTR
3	DVLV-101	Series 193 Brass (Chrome Plated) Valve
	DVLV-103	Series 193 Brass (Chrome Plated) SS handle Valve
4	RM-500	Valve Safety pin for DCP
5	RM-012	Safety pin holder (String)
6	RM-039	Lever Lock
7	RM-268	Temper seal
8	KCR-60	60gm Cartridge
9	HOSE-005	EPDM Hose
10	BASE-002	Bottom Base - 6LTR
	BASE-003	Bottom Base - 9LTR
11	LABLE-106	Transparent Lable - 9LTR
	LABLE-190	Transparent Lable - 6LTR
12	LABLE-107	Back side lable - 9LTR
	LABLE-191	Back side lable - 6LTR
15	JBRKT-001	J-Bracket for Cartridge type Fire extinguisher
	Optional Brackets	For this Please check bracket page

NOTICE : The equipment/spares presented in this bulletin is to be installed/assembled in accordance with the latest publication standards of BIS or EN and CERTIFIED LABS wherever applicable. The information provided by us is to the best of our knowledge and belief, and consist of general guidelines only. Product development is a continuous programme of KANADIA FYR FYTER PVT LTD and hence the right to modify any specification without prior notice is reserved with the company.

KANEX®

KANADIA FYR FYTER PVT. LTD.

Office No.502, 5th Floor, A wing, Damji Shamji Corporate Square, Ghatkopar -Andheri Link Road, Laxmi Nagar, Ghatkopar (E) - 400 075

• Ph. No. : +91 22 67250731/32

• Website : www.kanexfire.com• E-Mail : marketing@kanexfire.com

PART LIST FOR

1, 2 & 3 KG CARBON DIOXIDE (CO₂ GAS) PORTABLE TYPE FIRE EXTINGUISHER

MODEL NOs.

KFCRQ-1
KFCRQ-2
KFCRQ-3

KFCSQZRQ-1
KFCSQZRQ-2
KFCSQZRQ-3



Sr. No.	PART / ITEM CODE	DESCRIPTION
1	CO2BODY-001	CO2 Body - 1KG
	CO2BODY-002	CO2 Body - 2KG
	CO2BODY-003	CO2 Body - 3KG
2	CVLV-101	Wheel Type valve (Tekno)
	CVLV-104	Wheel Type valve (Other)
	CVLV-102	Squeeze Grip type valve
3	RM-001	Locking ring CO2 valve
4	RM-002	Locking pin CO2 Valve
5	ALPIPE-101	Aluminum Syphon tube - 1KG
	ALPIPE-102	Aluminum Syphon tube - 2KG
	ALPIPE-103	Aluminum Syphon tube - 3KG
6	HORN-004	Round horn
7	BNDPIPE-002	Bend Pipe (MS)
	BNDPIPE-001	Bend Pipe (Brass)
8	HNDLE-007	Carrying Handle (RAMA) - 1 & 2KG
	HNDLE-008	Carrying Handle (EKC) - 1 & 2 KG
	HNDLE-009	Carrying Handle - 3 KG
9	LABLE-093	Transparent lable - CO2 2kg Wheel type
	LABLE-127	Transparent lable - CO2 3kg Wheel type
	LABLE-142	Transparent lable - CO2 2kg SQ. grip type
	LABLE-143	Transparent lable - CO2 3kg SQ. grip type
10	LABLE-095	Back side lable
11	WBRKT-004	Wall mouting bracket For wheel type valve extinguisher
	WBRKT-005	Wall mouting bracket For Squeeze grip type valve extinguisher

NOTICE : The equipment/spares presented in this bulletin is to be installed/assembled in accordance with the latest publication standards of BIS or EN and CERTIFIED LABS wherever applicable. The information provided by us is to the best of our knowledge and belief, and consist of general guidelines only. Product development is a continuous programme of KANADIA FYR FYTER PVT LTD and hence the right to modify any specification without prior notice is reserved with the company.

KANEX®

KANADIA FYR FYTER PVT. LTD.

Office No.502, 5th Floor, A wing, Damji Shamji Corporate Square,
Ghatkopar -Andheri Link Road, Laxmi Nagar, Ghatkopar (E) - 400 075

• Ph. No. : +91 22 67250731/32

• Website : www.kanexfire.com

• E-Mail : marketing@kanexfire.com

PART LIST FOR

4.5 KG CARBON DIOXIDE (CO₂ GAS) PORTABLE TYPE FIRE EXTINGUISHER

MODEL NOS.

KFCRQ-4.5

KFCSQZRQ-4.5



Sr. No.	PART / ITEM CODE	DESCRIPTION
1	CO2BODY-004	CO2 Body - 4.5KG
2	CVLV-101	Wheel Type valve (Tekno)
	CVLV-104	Wheel Type valve (Other)
	CVLV-102	Squeeze Grip type valve
3	RM-001	Locking ring CO2 valve
4	RM-002	Locking pin CO2 Valve
5	ALPIPE-104	Aluminum Syphon tube - 4.5KG
	BPIPE-118	Brass Syphon tube - 4.5KG
6	HOSE-015	Wire Braided Hose
	HOSE-063	Wire Braided Hose - SAE 100 R1 - Parker
	HOSE-068	Regular Hose - 1Mtr
7	HORN-001	Flat horn
	HORN-002	Round horn
8	HNDLE-009	Carrying Handle
9	LABLE-094	Transparent lable - CO2 4.5kg Wheel type
	LABLE-144	Transparent lable - CO2 4.5kg Sq. grip type
10	LABLE-095	Back side lable
11	WBRKT-004	Wall mouting bracket For wheel type valve extinguisher
	WBRKT-005	Wall mouting bracket For Squeeze grip type valve extinguisher

NOTICE : The equipment/spares presented in this bulletin is to be installed/assembled in accordance with the latest publication standards of BIS or EN and CERTIFIED LABS wherever applicable. The information provided by us is to the best of our knowledge and belief, and consist of general guidelines only. Product development is a continuous programme of KANADIA FYR FYTER PVT LTD and hence the right to modify any specification without prior notice is reserved with the company.

KANEX[®]

KANADIA FYR FYTER PVT. LTD.

Office No.502, 5th Floor, A wing, Damji Shamji Corporate Square,
Ghatkopar -Andheri Link Road, Laxmi Nagar, Ghatkopar (E) - 400 075

• Ph. No. : +91 22 67250731/32

• Website : www.kanexfire.com

• E-Mail : marketing@kanexfire.com

PART LIST FOR

SS BODY 2, 3, 4, 6 & 9 LTR K-TYPE (WET CHEMICAL) STORED PRESSURE PORTABLE TYPE FIRE EXTINGUISHER

MODEL NOs.

KFKHQ-2
KFKHQ-3
KFKHQ-4

KFKHQ-6
KFKHQ-9

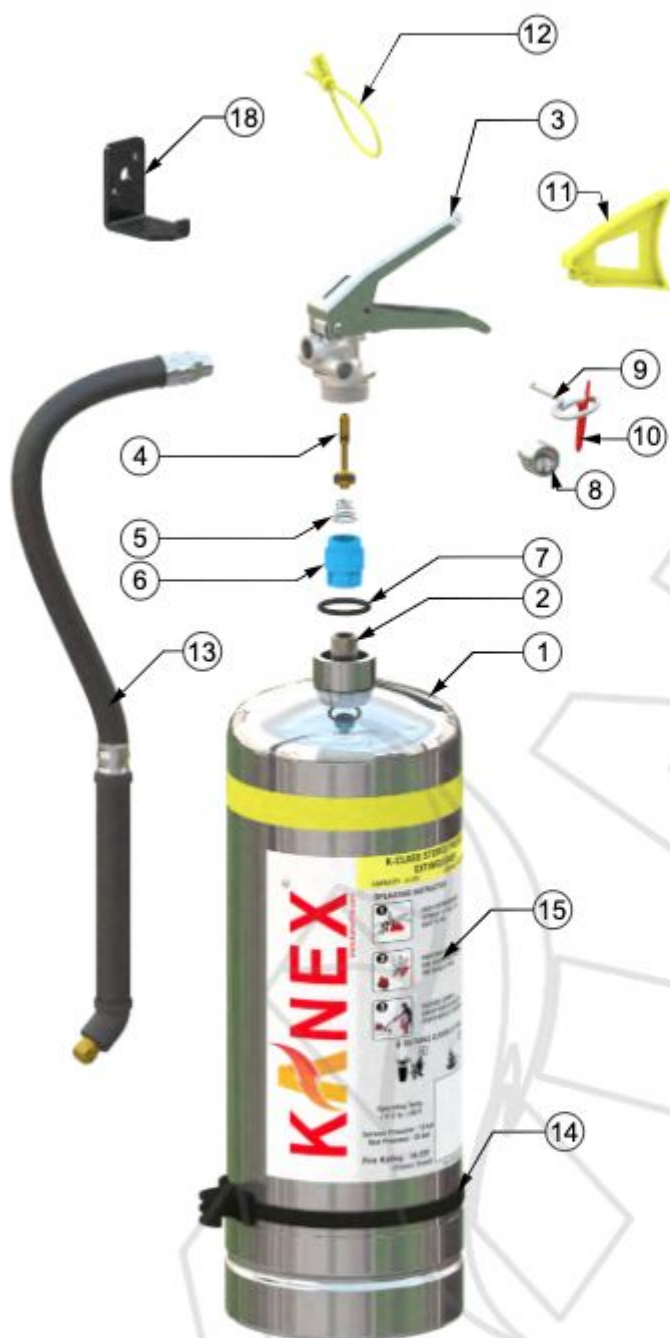

Sr. No.	PART / ITEM CODE	DESCRIPTION
1	ABCSSBODY-002	SS Body - 2 LTR
	ABCSSBODY-003	SS Body - 3 & 4 LTR
	ABCSSBODY-004	SS Body - 6 LTR
	ABCSSBODY-005	SS Body - 9 LTR
2	SSPIPE	SS Syphon tube - 2 LTR
	SSPIPE	SS Syphon tube - 3 & 4 LTR
	SSPIPE	SS Syphon tube - 6 LTR
	SSPIPE	SS Syphon tube - 9 LTR
3	AVLV-112	CE (Series 137) Brass (Chrome Plated) SS Lever Small Handle valve-115 mm
4	RM-300	Valve Spindle
5	RM-735	Valve Spring
6	RM-736	Syphon tube adaptor - PVC
	RM-550	Syphon tube adaptor - Aluminum
7	RM-248	O-Ring
8	PGAGE-102	Pressure gauge / Indicator
9	RM-384	Valve Safety pin
10	RM-012	Safety pin holder (String)
11	RM-039	Lever Lock
12	RM-268	Temper seal
13	HOSE	Hose with Discharge nozzle - 2,3 & 4 LTR
	HOSE	Hose with Discharge nozzle - 6 & 9 LTR
14	BELT-012	Pull type Belt - 2 LTR
	BELT-010	Pull type Belt - 3 & 4 LTR
	BELT-011	Pull type Belt - 6 & 9 LTR
15	LABLE	Lable - 2 LTR
	LABLE	Lable - 3 LTR
	LABLE	Lable - 4 LTR
	LABLE	Lable - 6 LTR
	LABLE	Lable - 9 LTR
16	LABLE-010	Back side lable
17	--	Wet chemical
18	WBRKT-013	Wall mounting Bracket for 2 Ltr with screw
	WBRKT-014	Wall mounting Bracket for 3 & 4 Ltr with screw
	WBRKT-015	Wall mounting Bracket for 6 Ltr with screw
	WBRKT-016	Wall mounting Bracket for 9 Ltr with screw
	Optional Brackets	For this Please check bracket page

NOTICE : The equipment/spares presented in this bulletin is to be installed/assembled in accordance with the latest publication standards of BIS or EN and CERTIFIED LABS wherever applicable. The information provided by us is to the best of our knowledge and belief, and consist of general guidelines only. Product development is a continuous programme of KANADIA FYR FYTER PVT LTD and hence the right to modify any specification without prior notice is reserved with the company.

KANEX®

KANADIA FYR FYTER PVT. LTD.

Office No.502, 5th Floor, A wing, Damji Shamji Corporate Square, Ghatkopar -Andheri Link Road, Laxmi Nagar, Ghatkopar (E) - 400 075

• Ph. No. : +91 22 67250731/32

• Website : www.kanexfire.com• E-Mail : marketing@kanexfire.com

PART LIST FOR 4, 6 & 9 KG D-TYPE METAL FIRE STORED PRESSURE PORTABLE TYPE FIRE EXTINGUISHER

MODEL NOs.

KFDMSRQ-4
KFDMSRQ-6
KFDMSRQ-9

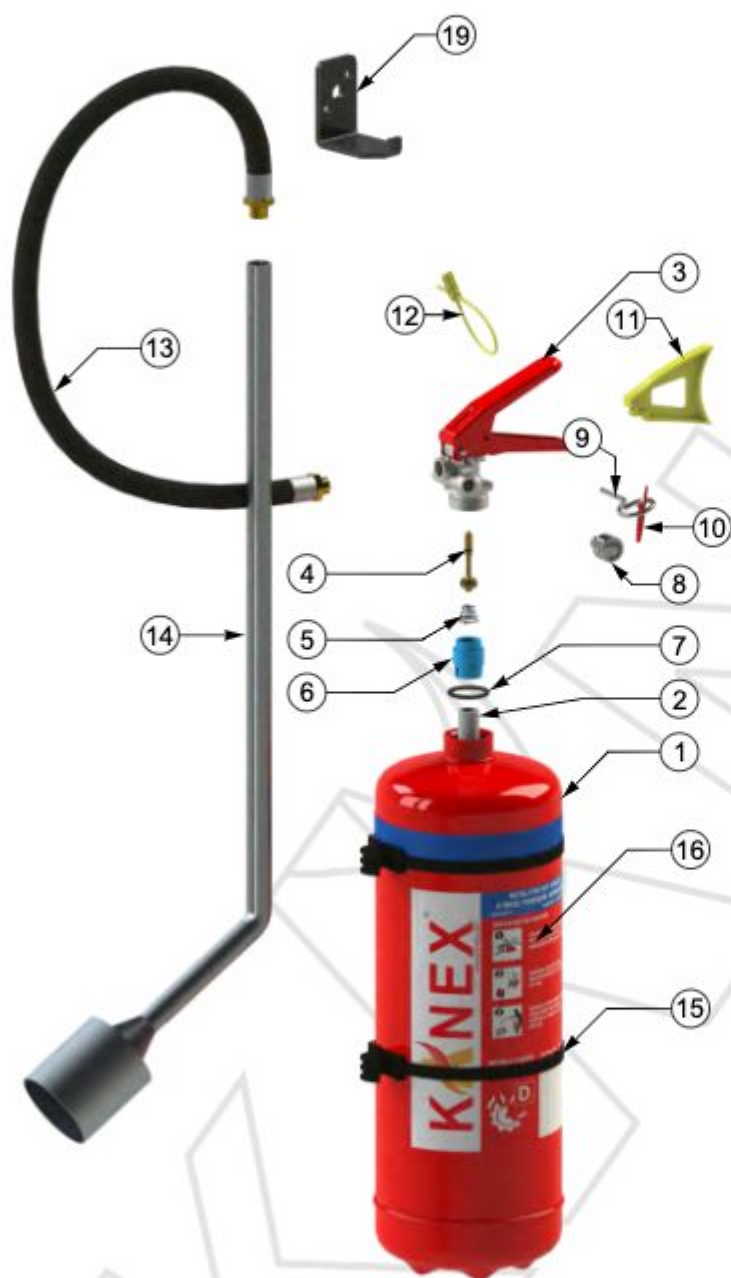

Sr. No.	PART / ITEM CODE	DESCRIPTION
1	PCOATEDABODY-3	Powder coated body - 4KG
	PCOATEDABODY-4	Powder coated body - 6KG
	PCOATEDABODY-5	Powder coated body - 9KG
2	ALPIPE-122	Outer Aluminum Syphon tube - 4KG
	ALPIPE-123	Outer Aluminum Syphon tube - 6KG
	ALPIPE-121	Outer Aluminum Syphon tube - 9KG
	BPIPE-103	Outer Brass Syphon tube - 4KG
	BPIPE-104	Outer Brass Syphon tube - 6KG
	BPIPE-105	Outer Brass Syphon tube - 9KG
	PPIPE-103	Outer Plastic Syphon tube - 4KG
	PPIPE-104	Outer Plastic Syphon tube - 6KG
	PPIPE-105	Outer Plastic Syphon tube - 9KG
3	AVLV-107	Non-CE (Series 137) Brass (Chrome Plated) Small Handle valve-115 mm
	AVLV-103	CE (Series 137) Brass (Chrome Plated) Small Handle valve-115 mm
	AVLV-104	CE (Series 137) Brass (Chrome Plated) Big Handle valve-140 mm
	AVLV-112	CE (Series 137) SS Small Handle valve-115 mm
	AVLV-111	CE (Series 137) SS Big Handle valve-140 mm
4	RM-300	Valve Spindle
5	RM-735	Valve Spring
6	RM-736	Syphon tube adaptor - PVC
	RM-550	Syphon tube adaptor - Aluminum
7	RM-248	O-Ring
8	PGAGE-101	Pressure gauge / Indicator
9	RM-384	Valve Safety pin
10	RM-012	Safety pin holder (String)
11	RM-039	Lever Lock
12	RM-268	Temper seal
13	HOSE	EPDM Hose
14	NOZAL-028	Aluminum Applicator type nozzle
15	BELT-011	Belt
16	LABLE	Front side Lable
17	LABLE	Back side lable
18	POWDR	TEC based Dry powder
19	WBRKT-014	Wall mounting Bracket for 4 kg with screw
	WBRKT-015	Wall mounting Bracket for 6 kg with screw
	WBRKT-016	Wall mounting Bracket for 9 kg with screw
	Optional Brackets	For this Please check bracket page

NOTICE : The equipment/spares presented in this bulletin is to be installed/assembled in accordance with the latest publication standards of BIS or EN and CERTIFIED LABS wherever applicable. The information provided by us is to the best of our knowledge and belief, and consist of general guidelines only. Product development is a continuous programme of KANADIA FYR FYTER PVT LTD and hence the right to modify any specification without prior notice is reserved with the company.

KANEX[®]

KANADIA FYR FYTER PVT. LTD.

Office No.502, 5th Floor, A wing, Damji Shamji Corporate Square,
Ghatkopar -Andheri Link Road, Laxmi Nagar, Ghatkopar (E) - 400 075

• Ph. No. : +91 22 67250731/32

• Website : www.kanexfire.com

• E-Mail : marketing@kanexfire.com

PART LIST FOR

**25, 50, 75 & 150 KG POWDER
(SBC, PBC, MAP-50%, MAP-90% & MAP-90% UL LISTED)
TROLLEY MOUNTED TYPE FIRE EXTINGUISHER**

MODEL NOs.

KFDRQ-25-S	KFDRQ-50-S	KFDRQ-75-S	KFDRQ-150-S
KFDRQ-25-P	KFDRQ-50-P	KFDRQ-75-P	KFDRQ-150-P
KFDRQ-25-50%	KFDRQ-50-50%	KFDRQ-75-50%	KFDRQ-150-50%
KFDRQ-25-90%	KFDRQ-50-90%	KFDRQ-75-90%	KFDRQ-150-90%
KFDHQ-25-UL90%	KFDHQ-50-UL90%	KFDHQ-75-UL90%	KFDHQ-150-UL90%



Sr. No.	PART / ITEM CODE	DESCRIPTION
1	PCOATEDDBODY-004	3.15 mm Thk. Regular Body - 25KG
	PCOATEDDBODY-005	6 mm Thk. Regular Body - 25KG
	PCOATEDDBODY-011	6 mm BQ Body - 25KG
	PCOATEDDBODY-006	4 mm Thk. Regular Body - 50KG
	PCOATEDDBODY-012	6 mm Thk. Regular Body - 50KG
	PCOATEDDBODY-0013	6 mm BQ Body - 50KG
	PCOATEDDBODY-007	4 mm Thk. Regular Body - 75KG
	PCOATEDDBODY-016	6 mm Thk. Regular Body - 75KG
	PCOATEDDBODY-017	6 mm BQ Body - 75KG
2	CAP-001	3" CAP - Brass
	CAP-002	3" CAP - SS
3	RM-380	Rubber washer - Cap
4	FCO2BODY-001	Filled 1KG CO2 cylinder - 25KG
	FCO2BODY-002	Filled 2KG CO2 cylinder - 50 & 75KG
5	HOSE-065	Parker CO2 connection hose (Wire Braided)
	HOSE-009	PVC Braided 3 mtr Long Hose - 25KG
	HOSE-025	Parker SAE-100-R6 3 mtr long Hose - 25KG
	HOSE-010	PVC Braided 5 mtr Long Hose - 50 & 75KG
	HOSE-024	Parker SAE-100-R6 5 mtr long Hose - 50 & 75KG
7	NOZAL-011	Aluminium Ball Valve Type Nozzle
	NOZAL-012	Trigger Type Nozzle
8	CAP-005	1.5" Drain Plug (S.S)
	CAP-006	1.5" Drain Plug (Brass)
	CAP-012	1.5" Drain Plug (Brass) (MALE)
9	RM-636	Rubber washer - Drain plug
10	TRLYWHL-003	Trolley Wheel - 25 & 50 KG
	TRLYWHL-004	Trolley Wheel - 75 KG
11	PGAGE-103	0 TO 28 Pressure Gauge
	PGAGE-111	0 to 42 Glisrin Filled
	LABLE-114	MAP Powder lable - 25KG
12	LABLE-115	BC Powder Lable - 25KG
	LABLE-116	MAP Powder lable - 50KG
	LABLE-117	BC Powder Lable - 50KG
	LABLE-118	MAP Powder lable - 75KG
	LABLE-119	BC Powder Lable - 75KG
13	POWDR-011	SBC Powder
	POWDR-015	PBC Powder
	POWDR-008	MAP-50% Powder
	POWDR-017	MAP-90% Powder
	POWDR-007	MAP-90% Powder - UL Listed

NOTICE : The equipment/spares presented in this bulletin is to be installed/assembled in accordance with the latest publication standards of BIS or EN and CERTIFIED LABS wherever applicable. The information provided by us is to the best of our knowledge and belief, and consist of general guidelines only. Product development is a continuous programme of KANADIA FYR FYTER PVT LTD and hence the right to modify any specification without prior notice is reserved with the company.

KANADIA FYR FYTER PVT. LTD.

Office No.502, 5th Floor, A wing, Damji Shamji Corporate Square,
Ghatkopar -Andheri Link Road, Laxmi Nagar, Ghatkopar (E) - 400 075

• Ph. No. : +91 22 67250731/32

• Website : www.kanexfire.com

• E-Mail : marketing@kanexfire.com

PART LIST FOR

25, 50, 75 KG D-TYPE METAL FIRE DRY POWDER
TROLLEY MOUNTED TYPE FIRE EXTINGUISHER

MODEL NOS.

KFDMRQ-25
KFDMRQ-50
KFDMRQ-75



Sr. No.	PART / ITEM CODE	DESCRIPTION
1	PCOATEDDBODY-004	3.15 mm Thk. Regular Body - 25KG
	PCOATEDDBODY-005	6 mm Thk. Regular Body - 25KG
	PCOATEDDBODY-011	6 mm BQ Body - 25KG
	PCOATEDDBODY-006	4 mm Thk. Regular Body - 50KG
	PCOATEDDBODY-012	6 mm Thk. Regular Body - 50KG
	PCOATEDDBODY-0013	6 mm BQ Body - 50KG
	PCOATEDDBODY-007	4 mm Thk. Regular Body - 75KG
	PCOATEDDBODY-016	6 mm Thk. Regular Body - 75KG
2	PCOATEDDBODY-017	6 mm BQ Body - 75KG
	CAP-001	3" CAP - Brass
3	CAP-002	3" CAP - SS
	RM-380	Rubber washer - Cap
4	N2BODY	Filled 3 Ltr Nitrogen cylinder - 25KG
	N2BODY	Filled 6.8 Ltr CO2 cylinder - 50 & 75KG
5	REGULATOR	Nitrogen cylinder pressure regulator
	HOSE-065	Parker CO2 connection hose (Wire Braided)
	HOSE-009	PVC Braided 3 mtr Long Hose - 25KG
	HOSE-025	Parker SAE-100-R6 3 mtr long Hose - 25KG
	HOSE-010	PVC Braided 5 mtr Long Hose - 50 & 75KG
6	HOSE-024	Parker SAE-100-R6 5 mtr long Hose - 50 & 75KG
	NOZAL-029	Aluminium Applicator
7	CAP-005	1.5" Drain Plug (S.S)
	CAP-006	1.5" Drain Plug (Brass)
	CAP-012	1.5" Drain Plug (Brass) (MALE)
8	RM-636	Rubber washer - Drain plug
	TRLYWHL-003	Trolley Wheel - 25 & 50 KG
9	TRLYWHL-004	Trolley Wheel - 75 KG
	LABLE	Lable
10	POWDR	TEC Dry Powder

NOTICE : The equipment/spares presented in this bulletin is to be installed/assembled in accordance with the latest publication standards of BIS or EN and CERTIFIED LABS wherever applicable. The information provided by us is to the best of our knowledge and belief, and consist of general guidelines only. Product development is a continuous programme of KANADIA FYR FYTER PVT LTD and hence the right to modify any specification without prior notice is reserved with the company.

KANEX[®]

KANADIA FYR FYTER PVT. LTD.

Office No.502, 5th Floor, A wing, Damji Shamji Corporate Square,
Ghatkopar -Andheri Link Road, Laxmi Nagar, Ghatkopar (E) - 400 075

• Ph. No. : +91 22 67250731/32

• Website : www.kanexfire.com

• E-Mail : marketing@kanexfire.com

PART LIST FOR

6.5, 9, 22.5 & 45 KG CARBON DIOXIDE (CO₂ GAS) TROLLEY MOUNTED TYPE FIRE EXTINGUISHER

MODEL NOs.

KFCRQ-6.5
KFCRQ-9
KFCRQ-22.5
KFCRQ-45



Sr. No.	PART / ITEM CODE	DESCRIPTION
1	CO2BODY-005	CO2 Body - 6.5KG
	CO2BODY-006	CO2 Body - 9KG
	CO2BODY-007	CO2 Body - 22.5KG
	CO2BODY-008	CO2 Body - 45KG
2	CVLV-101	Wheel type valve (Tekno)
	CVLV-104	Wheel Type valve (Other)
3	RM-001	Locking ring CO2 valve
4	RM-002	Locking pin CO2 Valve
5	ALPIPE-105	Aluminum Syphon tube - 6.5KG
	BPIPE-120	Brass Syphon tube - 6.5KG
	ALPIPE-106	Aluminum Syphon tube - 9KG
	BPIPE-119	Brass Syphon tube - 9KG
	ALPIPE-107	Aluminum Syphon tube - 22.5KG
	BPIPE-121	Brass Syphon tube - 22.5KG
6	ALPIPE-113	Aluminum Syphon tube - 45KG
	BPIPE-122	Brass Syphon tube - 45KG
	HOSE-016	Wire Braided Hose - 2Mtr (6.5 & 9 KG)
	HOSE-017	Wire Braided Hose - 5Mtr (22.5 KG)
	HOSE-019	Wire Braided Hose - 10Mtr (22.5 & 45 KG)
	HOSE-020	Wire Braided Hose - 15Mtr (22.5 & 45 KG)
7	HOSE-021	Wire Braided Hose - 30Mtr (22.5 & 45 KG)
	HOSE-052	Wire Braided Hose - SAE 100 R1 - Parker - 2Mtr
	HORN-001	Flat horn
	HORN-002	Round horn - 6.5 KG
	HORN-003	Round horn - 9 & 22.5 KG
8	TROLY-002	Mobile Trolley - 6.5KG
	TROLY-003	Mobile Trolley - 9KG
	TROLY-004	Mobile Trolley - 22.5KG
	TROLY-005	Mobile Trolley - 45KG
9	TRLYWHL-001	Trolley wheel - 6.5 & 9 KG
	TRLYWHL-002	Trolley wheel - 22.5 & 45 KG
10	LABLE-096	Transparent lable - 6.5 KG
	LABLE-145	Transparent lable - 9 KG
	LABLE-097	Transparent lable - 22.5 KG

NOTICE : The equipment/spares presented in this bulletin is to be installed/assembled in accordance with the latest publication standards of BIS or EN and CERTIFIED LABS wherever applicable. The information provided by us is to the best of our knowledge and belief, and consist of general guidelines only. Product development is a continuous programme of KANADIA FYR FYTER PVT LTD and hence the right to modify any specification without prior notice is reserved with the company.

KANEX[®]

KANADIA FYR FYTER PVT. LTD.

Office No.502, 5th Floor, A wing, Damji Shamji Corporate Square,
Ghatkopar -Andheri Link Road, Laxmi Nagar, Ghatkopar (E) - 400 075

• Ph. No. : +91 22 67250731/32

• Website : www.kanexfire.com

• E-Mail : marketing@kanexfire.com

PART LIST FOR

45 & 60 LTR MECHANICAL FOAM (AFFF + WATER) OR (AR-AFFF + WATER) TROLLEY MOUNTED TYPE FIRE EXTINGUISHER

MODEL NOs.

KFMRQ-45
KFMRQ-60



Sr. No.	PART / ITEM CODE	DESCRIPTION
1	PCOATEDMWBODY-005	Powder coated empty body - 45Ltr
	PCOATEDMWBODY-006	Powder coated empty body - 60Ltr
2	KCR-300	300gm CO2 gas Cartridge
3	HOSE-007	Hose - 45 & 60 Ltr
4	NOZAL-008	Aluminum Nozzle
5	RM-090	3/8" Ball valve - Brass
6	CAP-003	Plunger type Cap
7	RM-380	Rubber washer - Cap
8	CAP-006	Drain cap
9	RM-636	Rubber washer - Drain plug
10	TRLYWHL-003	Trolley wheel
11	LABLE-171	Transparent Lable - 45 LTR
	LABLE-179	Transparent Lable - 60 LTR
12	MRIFIL-002	Mechanical Foam Refill - 45 & 60Ltr
	MRIFIL-001	Mechanical Foam Refill - 60Ltr (In addition to MRIFIL - 002)
	MRIFIL-006	AR-AFFF Foam 3 Ltr
	MRIFIL-004	Mechanical Foam Refill - 60Ltr (In addition to MRIFIL - 006)

NOTICE : The equipment/spares presented in this bulletin is to be installed/assembled in accordance with the latest publication standards of BIS or EN and CERTIFIED LABS wherever applicable. The information provided by us is to the best of our knowledge and belief, and consist of general guidelines only. Product development is a continuous programme of KANADIA FYR FYTER PVT LTD and hence the right to modify any specification without prior notice is reserved with the company.

KANEX[®]

KANADIA FYR FYTER PVT. LTD.

Office No.502, 5th Floor, A wing,Damji Shamji Corporate Square, Ghatkopar -Andheri Link Road,Laxmi Nagar,Ghatkopar (E) - 400 075

• Ph. No. : +91 22 67250731/32

• Website : www.kanexfire.com• E-Mail : marketing@kanexfire.com

PART LIST FOR

2, 5, 10 & 15 KG MODULAR STORED PRESSURE (MAP-50%, MAP-90% & MAP-90% UL LISTED) CEILING MOUNTED TYPE FIRE EXTINGUISHER

MODEL NOs.

KMPRQ-2-50%	KMPRQ-5-50%
KMPRQ-2-90%	KMPRQ-5-90%
KMPHQ-2-UL90%	KMPHQ-5-UL90%

KMPRQ-10-50%	KMPRQ-15-50%
KMPRQ-10-90%	KMPRQ-15-90%
KMPHQ-10-UL90%	KMPHQ-15-UL90%



Sr. No.	PART / ITEM CODE	DESCRIPTION
1	PCOATEDMODBODY-001	Powder Coated Modular Empty body - 2 KG
	PCOATEDMODBODY-002	Powder Coated Modular Empty body - 5 KG
	PCOATEDMODBODY-003	Powder Coated Modular Empty body - 10 KG
	PCOATEDMODBODY-004	Powder Coated Modular Empty body - 15 KG
2	MDVLV-001	Brass Valve
3	RM-248	O-Ring
4	RM-193	Glass Bulb (57°C)
	RM-737	Glass Bulb (68°C)
5	PGAGE-101	Pressure Gauge
6	MSTAND-001	Mounting Stand
7	RM-199	Bullet Bolt
8	LABLE-146	Transparent Lable
9	POWDR-008	Mono Ammonium Phosphate based dry powder 50% (Confirms to IS:14609)
	POWDR-007	Mono Ammonium Phosphate based dry powder 90% (UL Listed)
	POWDR-017	Mono Ammonium Phosphate based dry powder 90%

NOTICE : The equipment/spares presented in this bulletin is to be installed/assembled in accordance with the latest publication standards of BIS or EN and CERTIFIED LABS wherever applicable. The information provided by us is to the best of our knowledge and belief, and consist of general guidelines only. Product development is a continuous programme of KANADIA FYR FYTER PVT LTD and hence the right to modify any specification without prior notice is reserved with the company.

KANEX®

KANADIA FYR FYTER PVT. LTD.

Office No.502, 5th Floor, A wing, Damji Shamji Corporate Square,
Ghatkopar -Andheri Link Road, Laxmi Nagar, Ghatkopar (E) - 400 075

• Ph. No. : +91 22 67250731/32

• Website : www.kanexfire.com

• E-Mail : marketing@kanexfire.com

PART LIST FOR

2, 5, 10 & 15 KG MODULAR STORED PRESSURE (CLEAN AGENT HFC-236fa & FE 36) CEILING MOUNTED TYPE FIRE EXTINGUISHER

MODEL NOs.

KMCRQ-2
KMCHQ-2-FE36

KMCRQ-5
KMCHQ-5-FE36

KMCRQ-10
KMCHQ-10-FE36

KMCRQ-15
KMCHQ-15-FE36



Sr. No.	PART / ITEM CODE	DESCRIPTION
1	PCOATEDMODBODY-001	Powder Coated Modular Empty body - 2 KG
	PCOATEDMODBODY-002	Powder Coated Modular Empty body - 5 KG
	PCOATEDMODBODY-003	Powder Coated Modular Empty body - 10 KG
	PCOATEDMODBODY-004	Powder Coated Modular Empty body - 15 KG
2	MDVLV-001	Brass Valve
3	RM-248	O-Ring
4	RM-193	Glass Bulb (57°C)
	RM-737	Glass Bulb (68°C)
5	PGAGE-101	Pressure Gauge
6	MSTAND-001	Mounting Stand
7	RM-199	Bullet Bolt
8	LABLE-147	Transparent Lable
9	GAS-005	Clean Agent FE36 gas
	GAS-006	Clean Agent HFC 236fa

NOTICE : The equipment/spares presented in this bulletin is to be installed/assembled in accordance with the latest publication standards of BIS or EN and CERTIFIED LABS wherever applicable. The information provided by us is to the best of our knowledge and belief, and consist of general guidelines only. Product development is a continuous programme of KANADIA FYR FYTER PVT LTD and hence the right to modify any specification without prior notice is reserved with the company.

KANEX®

KANADIA FYR FYTER PVT. LTD.

Office No.502, 5th Floor, A wing, Damji Shamji Corporate Square,
Ghatkopar -Andheri Link Road, Laxmi Nagar, Ghatkopar (E) - 400 075

• Ph. No. : +91 22 67250731/32

• Website : www.kanexfire.com

• E-Mail : marketing@kanexfire.com

PART LIST FOR

10 LTR WATER MIST CUM COMPRESSED AIR FOAM SYSTEM (CAFS) BACK PACK (PORTABLE) TYPE FIRE EXTINGUISHER

MODEL NOs.

KCAFSHQ-10

Sr. No.	PART / ITEM CODE	DESCRIPTION
1	PCOATEDCAFSBODY-001	SS Powder coated body
2		Mixing chamber with Wet & Dry mode knob
3		Reducer - 18bar
4		Discharge pistol
5	AVLV-116	Air Cylinder valve-300 bar
6	AIRBODY-003	Air cylinder Carbon composite - 2L
7	SSPIPE-004	SS Syphon
8	HOSE-088	EPDM Discharge hose
9	HOSE-089	SS Braided conection hose
10	RM-480	Backpack
11	LABLE-076	Transparent label
12		1/4" - 3/8" Adapter
13		1/4" - 1/4" Adapter
14	MRIFIL-009	AFFF - 3% Foam



NOTICE : The equipment/spares presented in this bulletin is to be installed/assembled in accordance with the latest publication standards of BIS or EN and CERTIFIED LABS wherever applicable. The information provided by us is to the best of our knowledge and belief, and consist of general guidelines only. Product development is a continuous programme of KANADIA FYR FYTER PVT LTD and hence the right to modify any specification without prior notice is reserved with the company.

KANEX[®]

KANADIA FYR FYTER PVT. LTD.

Office No.502, 5th Floor, A wing, Damji Shamji Corporate Square, Ghatkopar -Andheri Link Road, Laxmi Nagar, Ghatkopar (E) - 400 075

• Ph. No. : +91 22 67250731/32

• Website : www.kanexfire.com• E-Mail : marketing@kanexfire.com

PART LIST FOR

50 LTR WATER MIST CUM COMPRESSED AIR FOAM SYSTEM (CAFS) TROLLEY MOUNTED TYPE FIRE EXTINGUISHER

MODEL NOs.

KCAFSHQ-50

Sr. No.	PART / ITEM CODE	DESCRIPTION
1	HPCAFSBODY-001	SS Body
2	CAP-005	Drain plug - SS
3	RM-583	Mixing chamber with Wet & Dry mode knob
4	RM-739	Reducer - 18bar
5	RM-678	Discharge pistol
6	AVLV-116	Air Cylinder valve-300 bar
7	AIRBODY-001	Air cylinder - 6L
8	SSPIPE-005	SS Syphon
9	HOSE-090	EPDM Discharge hose
10	HOSE-091	SS Braided connection hose
11	TROLY-016	Mobile trolley
12	TRLYWHL-010	Trolley Wheel
13	LABLE-077	Transparent label-Upper
14	LABLE-091	Transparent label-Lower
15	RM-827	SS Sheet
16		1/4" - 3/8" Adapter
17		1/4" - 1/4" Adapter
18	MRIFIL-009	AFFF - 3% Foam - 3Ltr



NOTICE : The equipment/spares presented in this bulletin is to be installed/assembled in accordance with the latest publication standards of BIS or EN and CERTIFIED LABS wherever applicable. The information provided by us is to the best of our knowledge and belief, and consist of general guidelines only. Product development is a continuous programme of KANADIA FYR FYTER PVT LTD and hence the right to modify any specification without prior notice is reserved with the company.

KANEX[®]

KANADIA FYR FYTER PVT. LTD.

Office No.502, 5th Floor, A wing, Damji Shamji Corporate Square, Ghatkopar -Andheri Link Road, Laxmi Nagar, Ghatkopar (E) - 400 075

• Ph. No. : +91 22 67250731/32

• Website : www.kanexfire.com• E-Mail : marketing@kanexfire.com

PART LIST FOR ALL TYPES OF BRACKETS

Sr. No.	PART / ITEM CODE	DESCRIPTION
1	WBRKT-001	Wall Bracket for ABC 1 & 2 KG
	WBRKT-002	Wall Bracket for ABC 4 & 6 KG
	WBRKT-003	Wall Bracket for ABC 9 KG
2	WBRKT-004	Wall Bracket for CO2 2,3 & 4.5 KG
	WBRKT-005	Wall Bracket for CO2 2,3 & 4.5 KG Squeeze Grip
3	WBRKT-006	Wall Bracket for 4KG
	WBRKT-007	Wall Bracket for 9KG
	WBRKT-010	Wall Bracket for 6KG
4	WBRKT-008	Wall Bracket for 9KG
5	WBRKT-009	Wall Bracket for DCP 9KG
6	PBRKT-001	Patti bracket ABC 1KG OD
	PBRKT-002	Patti bracket ABC 2KG SML & OD
	PBRKT-003	Patti bracket ABC 1KG TM
	PBRKT-004	Patti bracket ABC 2KG TM
	PBRKT-005	Patti bracket ABC 4KG
	PBRKT-006	Patti bracket ABC 6KG
7	TBRKT-001	Tar Bracket ABC 1 KG Regular
	TBRKT-002	Tar bracket ABC 1 KG Special
8	TBRKT-003	Tar Bracket ABC 2 KG Regular
9	JBRKT-001	J-Type Wall Bracket For DCP 4,6,9 KG
10	WBRKT-012	Wall bracket for 1kg Fire Extinguisher
	WBRKT-013	Wall bracket for 2kg Fire Extinguisher
	WBRKT-014	Wall bracket for 4kg Fire Extinguisher
	WBRKT-015	Wall bracket for 6kg Fire Extinguisher
	WBRKT-016	Wall bracket for 9kg Fire Extinguisher

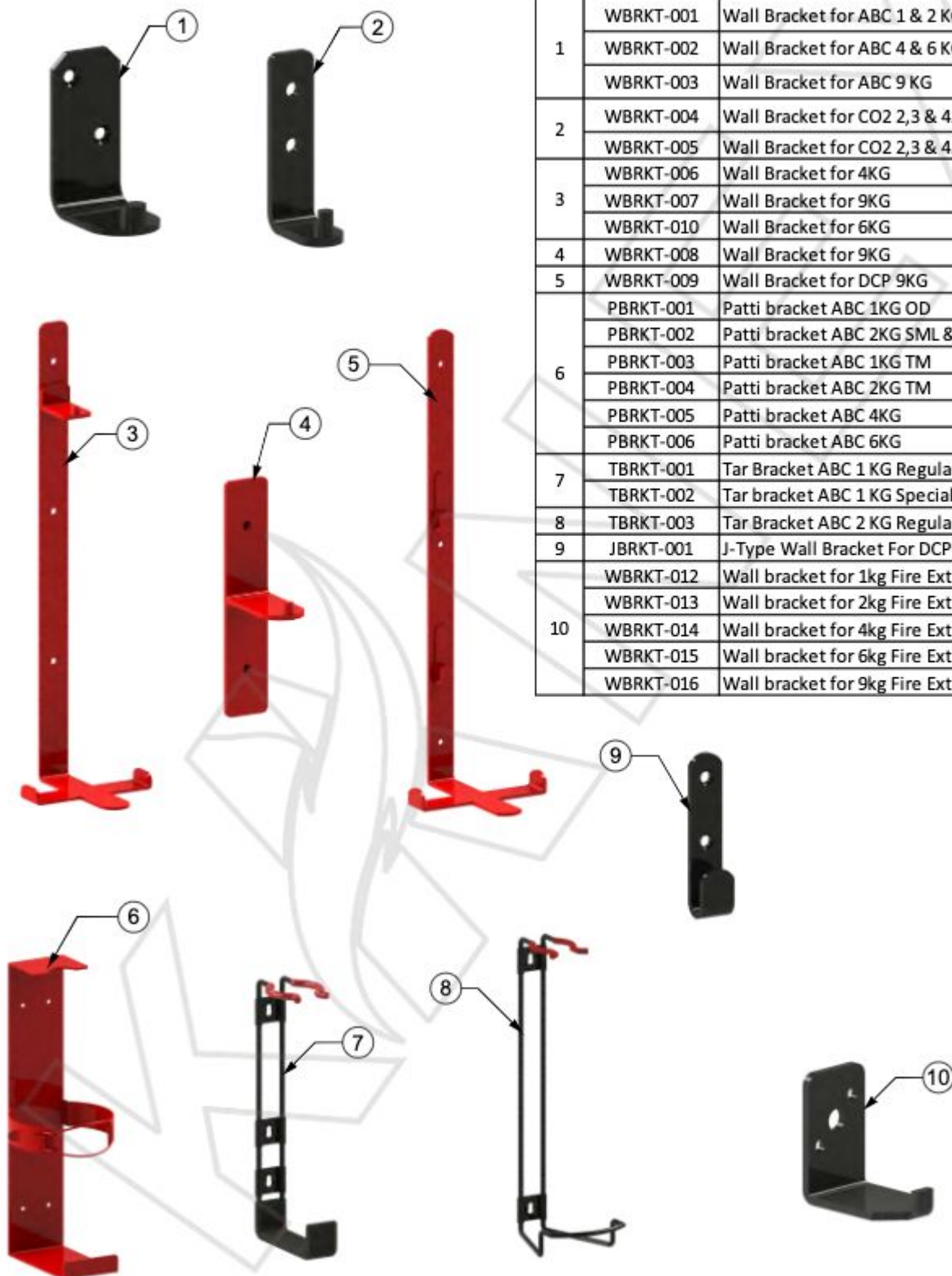

NOTICE : The equipment/spares presented in this bulletin is to be installed/assembled in accordance with the latest publication standards of BIS or EN and CERTIFIED LABS wherever applicable. The information provided by us is to the best of our knowledge and belief, and consist of general guidelines only. Product development is a continuous programme of KANADIA FYR FYTER PVT LTD and hence the right to modify any specification without prior notice is reserved with the company.

KANEX[®]

Shaping the future of Fire Protection

Designed, Manufactured & Marketed by:
KANADIA FYR FYTER PVT. LTD.
An ISO 9001:2015 Certified Company

HEAD OFFICE:

Office No.502, 5th Floor, A wing,
Damji Shamji Corporate Square, Ghatkopar -Andheri Link Road,
Laxmi Nagar,Ghatkopar (E)
Mumbai - 400 075
Contact No. - 022 25001288

info@kanexfire.com
www.kanexfire.com

Presence at - PAN INDIA

WORKS:

Plot No.7/8, Paras Industrial Estate,
Near Garibshah Pir, Sihor - 364240 (Guj.)
Ph. No.: +91 2846 231763/64



marketing@kanexfire.com
www.kanexfire.com