



TECHNICAL DATASHEET FOR
POWDER(TROLLEY MOUNTED) TYPE
FIRE EXTINGUISHER OF CAPACITY
50 KG

KANADIA FYR FYTER PVT. LTD
(An ISO 9001:2008 Certified Company)

KANEX DOC NO.: KFPL/GTP/H/CP/P/50

REV. 00

DATE: 01.07.2015

SHEET 1 OF 2

CLIENT

PROJECT

PO NO.

1.00 General

1.01	Manufacturer	Kanadia Fyr Fyter Pvt Ltd
1.02	Trade Mark	"KANEX"
1.03	Standard Code	IS:10658:1999
1.04	Type	Trolley Mounted Type
1.05	Whether Seal is provided to indicate that Extinguisher has not been used	Yes
1.06	Quantity	

2.00 Materials of Construction

2.01	Extinguishing Medium	Sodium Bi-Carbonate Powder-IS:4308
2.02	Body	M.S Sheet of IS:2062
2.03	Neck Ring	M.S Pipe of IS:1239
2.04	Cap	Brass IS:319
2.05	Cap Washer	Rubber
2.06	Siphon Tube(Inlet & Outlet)	M.S. Pipe (IS:3601)
2.07	CO2 gas Cylinder(2 kg)	As per IS:7285
2.08	CO2 gas	As per IS:15222
2.09	Discharge Hose	PVC Braided (Burst pressure \geq 50 kg/cm ²)
2.10	Discharge Nozzle	Aluminium alloy (IS:617)
2.11	Discharge Valve	IS:3224 (Wheel Type)
2.12	Trolley Wheel	Solid Rubber
2.13	Pressure Guage	Range : 0-28kg/cm ²
2.14	Carrying Handle	Mild steel

3.00 Guaranteed Performance

3.01	Capacity	50 kg (By weight of extinguishing charge)
3.02	Discharge Time	40 to 50 sec. (Actual:47 sec approx)
3.03	Range or Throw of Jet	8 meter min. (Actual:9 meter approx)
3.04	Percentage of Discharge	Not Less than 85 %. (Actual:91% approx)
3.05	Hydraulic Pressure Test	30 kg/cm ² for 2.5 minutes
3.06	Burst Test	45 kg/cm ²
3.07	Service Pressure/Expansion Space	Not to exceed 15 kg/cm ²
3.08	Construction Features	As per IS:10658:1999



**TECHNICAL DATASHEET FOR
POWDER(TROLLEY MOUNTED) TYPE
FIRE EXTINGUISHER OF CAPACITY
50 KG**

KANADIA FYR FYTER PVT. LTD
(An ISO 9001:2008 Certified Company)

3.09	Supplied First Charge Of Extinguisher Agent	Yes
------	---	-----

4.00	Dimensions	
4.01	Maximum Diameter of Fire Extinguisher	400±10 mm O/D approx
4.02	Overall Height of Extinguisher	1020 mm (Approx.)
4.03	Shell thickness	4 mm (Approx.)
4.04	Filler Opening	75 mm
4.05	Discharge Hose	L=5 meter I.D=19 mm
4.06	Full Weight	107 kg approx

5.00	Anti-Corrosive Treatment	Phosphate Treatment Followed by Epoxy Powder Coating of body DFT not less than 50 micron
-------------	---------------------------------	--

6.00	Accessories	
6.01	Carrying Handle	Provided
6.02	Wheels	Provided
6.03	All other Accessories as per IS:10658	Provided

7.00	Miscellaneous	
7.01	Inspection & Testing	As per approved GTP
7.02	Finish	PO Red as per IS : 5 (Shade 538)
7.03	Marking	As Per IS:10658:1999
7.04	Maintenance, Care and Refilling	As per IS 2190
8.00	Approvals	BIS
9.00	Packing	Suitable Jute Bags

DESIGN DATA :

STANDARD CODE	: IS 10658 : 1999
TYPE OF EXTINGUISHER	: TROLLEY MOUNTED TYPE
EXTINGUISHING MEDIUM	: SODIUM BI-CARBONATE POWDER- IS:4308
CLASS OF FIRE	: B & C
CAPACITY	: 50 KG.(BY WEIGHT OF EXTINGUISHING CHARGE)
DISCHARGE TIME	: MINIMUM 40 SEC. & MAXIMUM 50 SEC.(Actual:47 sec approx)
RANGE OF THROW OF JET	: NOT LESS THAN 8 METERS. (Actual:9 meters approx)
PERCENTAGE DISCHARGE	: NOT LESS THAN 85%
HYDRAULIC PRESSURE TEST	: 30 kg./cm ² FOR 2.5 MINUTES.
BURST PRESSURE SERVICE	: 55 kg./cm ² : NOT TO EXCEED 15 kg./cm ²
PRESSURE/EXPANSION SPACE	
DIA. OF BODY	: 400±10mm.O/D.(APPROX)
TOTAL HEIGHT	: 1020mm (APPROX)
FINISH	: PO RED AS PER IS:5 (SHADE - 538)
MARKING	: AS PER IS:10658 - 1999

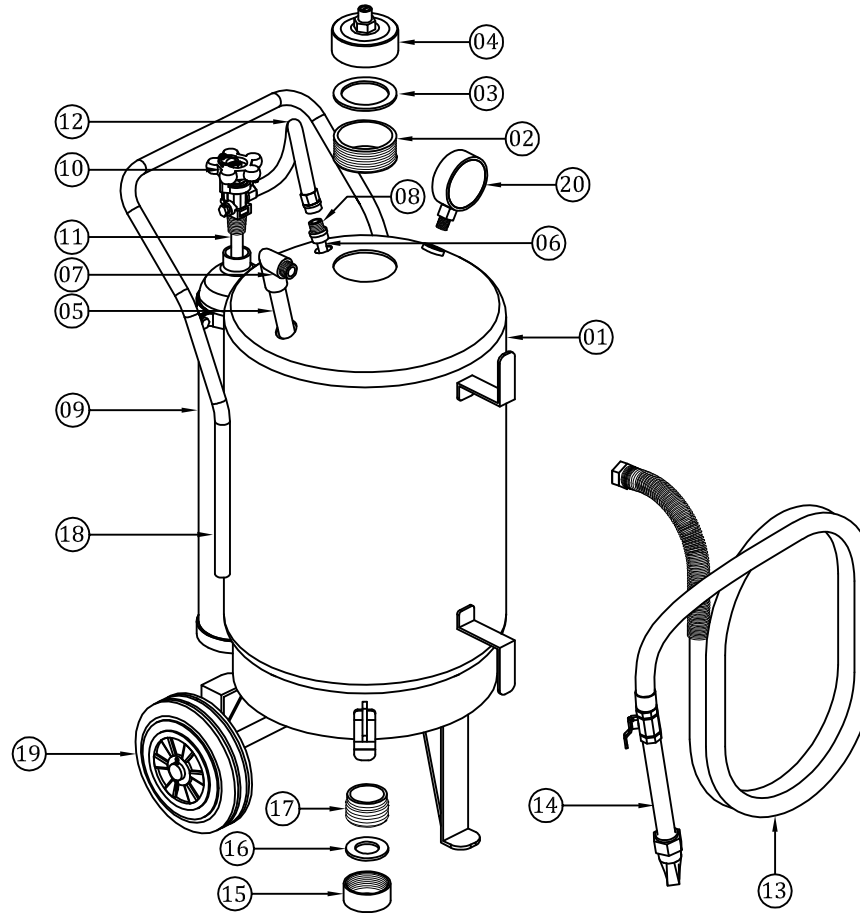

20.	PRESSURE GAUGE	: 0 TO 28 KG/cm ²
19.	TROLLEY WHEEL	: SOLID RUBBER
18.	TROLLEY HANDLE	: M.S.PIPE
17.	DRAIN PLUG NECK RING:	M.S.
16.	DRAIN PLUG WASHER	: RUBBER
15.	DRAIN PLUG	: BRASS
14.	DISCHARGE NOZZLE	: ALUMINIUM ALLOY IS:617
13.	DISCHARGE HOSE	: PVC BRAIDED (BURST PRESSURE ≥50kg/cm ²)
12.	CO2 CONNECTION HOSE:	WIRE BRAIDED
11.	CO2 SYPHONE TUBE	: ALUMINIUM
10.	DISCHARGE VALVE	: CONFIRM TO IS : 3224
09.	CO2 GAS CYLINDER (2 KG)	: AS PER IS:7285
08.	SYPHONE TUBE ADAPTOR	: M.S.
07.	DISCHARGE LBOW	: M.S.
06.	SIPHONE TUBE (INLET)	: M.S.
05.	SIPHONE TUBE (OUTLET)	: M.S. PIPE TO IS:3601
04.	CAP	: BRASS TO IS : 319
03.	WASHER	: RUBBER
02.	NECK RING	: M.S.PIPE OF IS:1239 (Part-1)
01.	BODY	: M.S. SHEET OF IS:2062

00.00.00	00.00.00		APP'D	A.Shah		01.07.15
00.00.00	00.00.00		CHK'D	Naresh		01.07.15
00.00.00	00.00.00		DR'N	RNG		01.07.15

KANEX
(AN ISO-9001-2008 CERTIFIED CO.)
 PLOT NO - 7, PARAS IND. ESTATE, NEAR GARIBISHA PIR,
 SIHOR -364 240.(GU.) e-mail: tech2@kanexfire.com

OWNER/CLIENT		XXX XXX XXX XX XXX	
CONTRACTOR		XXX XXX XXX XX XXX	
PO.No.	XXX XXX XXX XX XXX		
TITLE HIGHER CAPACITY DRY POWDER FIRE EXTINGUISHER 50 KG CAPACITY.(TROLLEY MOUNTED)			
PROJECT	XXX XXX XXX XX XXX	Scale	NTS
DRG.No.	KFPL/GAD/H/CP/P/50	Project	
		Sheet	REV.
		1 of 1	00

Sr.No	Item Description	Materials of Constructions
1		
2		
3		

Date	Rev.Dt	Description	XXX	Name	Sign.	Date