



**TECHNICAL DATASHEET FOR CO2
PORTABLE TYPE FIRE EXTINGUISHER
OF CAPACITY 2 KG**

KANADIA FYR FYTER PVT. LTD
(An ISO 9001:2008 Certified Company)

KANEX DOC NO.: KFPL/GTP/P/SHP/C/2

REV. 00

DATE: 01.07.2015

SHEET 1 OF 2

CLIENT

PROJECT

PO NO.

1.00 General

1.01 Manufacturer Kanadia Fyr Fyter Pvt Ltd

1.02 Trade Mark "KANEX"

1.03 Standard Code IS 15683:2006

1.04 Type Portable-High Pressure Type

1.05 Whether Seal is provided to indicate that Extinguisher has not been used Yes

1.06 Quantity

2.00 Materials of Construction

2.01 Extinguishing Medium CO2 Gas (Purity as per IS: 15222-99.5%)

2.02 Body Seamless Manganese Steel-ISI marked confirms to IS:7285

2.03 Discharge Valve(Wheel Type) Confirms to IS:3224

2.04 Discharge Horn Non-Conductor Of Electricity-Polyethylene

2.05 Siphon Tube Aluminium

2.06 Wall mounting Bracket Mild steel (Powder Coated)

3.00 Guaranteed Performance

3.01 Capacity 2 kg (Tolerance $\pm 5\%$ by mass)

3.02 Minimum effective Discharge Time Minimum : 8 Sec. (Actual : 12 Sec. approx)

3.03 Bulk Range of Discharge Minimum 2 meter (Actual : 2 meter approx)

3.04 Percentage of Discharge Not Less than 95 % (Actual : 97% approx)

3.05 Fire Rating 8B

3.06 Temperature Range -30 °C to +55 °C

3.07 Working Pressure 60-70 bar

3.08 Pressure Test 250 bar

3.09 Fill Density Not to Exceed 0.667 percent

4.00 Routine Tests

4.01 Leakage test By Dipping in water leakage to checked

4.02 Partial discharge The second pressure or weight shall not be less than 75% of the first after interruption of the Discharge.



**TECHNICAL DATASHEET FOR CO2
PORTABLE TYPE FIRE EXTINGUISHER
OF CAPACITY 2 KG**

KANADIA FYR FYTER PVT. LTD
(An ISO 9001:2008 Certified Company)

5.00	Extinguishers also pass through the Following Tests (Type tests)	
5.01	Resistance to Temperature changes	
5.02	Resistance to Impact test	
5.03	Tapping Test	
5.04	Resistance to Vibration test	
5.05	Intermittent Discharge test	
5.06	Fire performance test	
5.07	Maximum Service Pressure	
6.00	Dimensions	
6.01	Maximum Diameter of Fire Extinguisher	108±10 mm.
6.02	Overall Height of Extinguisher	580 mm (Approx.)
6.03	Shell thickness	3.5mm or 4mm (Minimum)
6.04	Full weight of cylinder	8.3 kg or 8.9kg (Approx)
7.00	Colour Of Extinguisher body	Painted With Durable Enamel PO red shade No.538 of IS:5
8.00	Accessories (brackets & screws)	Provided
9.00	Miscellaneous	
9.01	Inspection & Testing	As per approved GTP
9.02	Finish	PO Red as per IS : 5 (Shade 538)
9.03	Marking	As per IS 15683:2006
9.04	Approvals	BIS
9.05	Maintenance, Care and Refilling	As per IS 2190
10.0	Packing	Jute Bag (Length:762 mm Width:242 mm)

DESIGN DATA		
Sr No.	PARTICULARS	DESCRIPTION
01	Capacity	2 kg (Tolerance +5% by mass)
02	Temperature range	-30°C to +55°C
03	Working pressure	60-70 bar
04	Pressure test (Pt) Pressure	Min. 250 bar
PERFORMANCE PARAMETERS		
01	Effective discharge time	Minimum : 8 Sec. (Actual:12 sec approx)
02	Bulk range of discharge	Minimum : 2 meter (Actual:2 meter approx)
03	Percentage of discharge	Not less than 95% (Actual:97% approx)
04	Fire Rating	8B

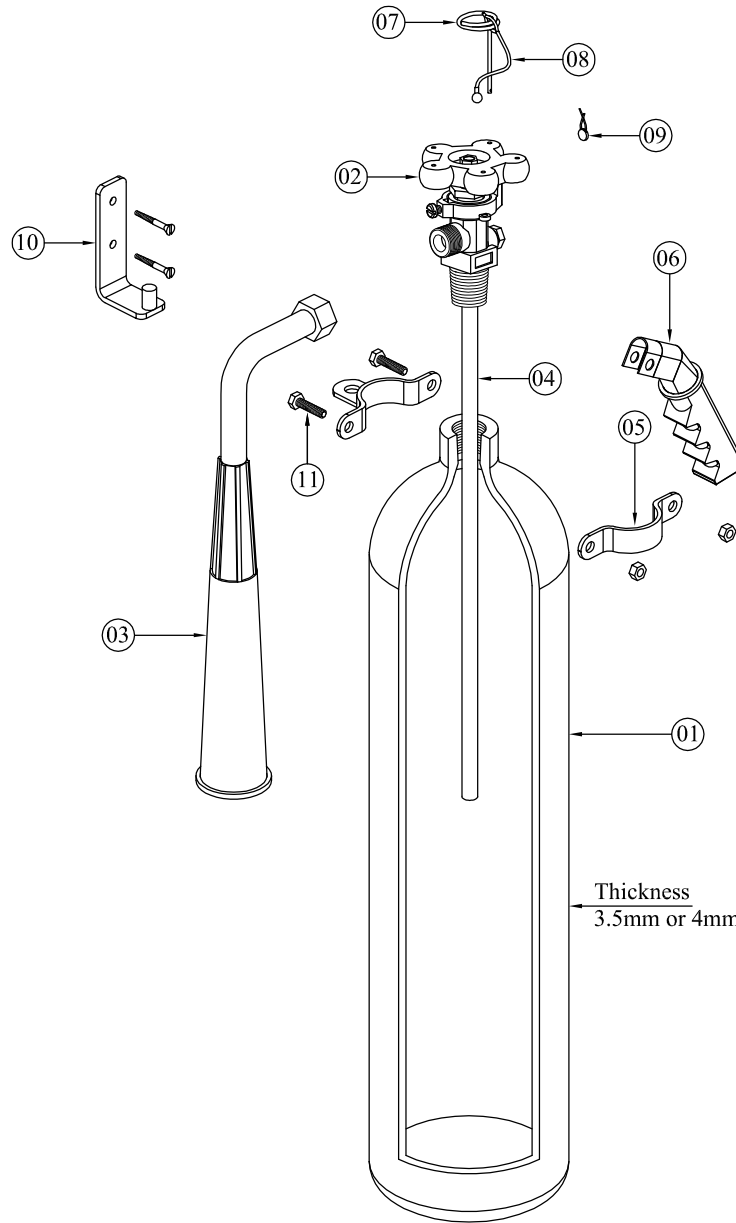

MARKING	AS PER IS:15683-2006
APPROVAL	BIS-ISI MARKED

12.	Extinguishing medium	CO ₂ Gas (Purity as per IS 15222-99.5 %)
11.	Nut/Bolt	M.S.(Galvanized)
10.	Wall mounting bracket With Screw	Mild steel (Powder coated)
09.	Seal	Lead
08.	Safety pin Holder	Soft PVC
07.	Safety pin	M.S.(Hard Chromed)
06.	Handle	Mild steel with rubber grip
05.	Clamp	M.S.
04.	Siphone tube	Aluminum
03.	Discharge Horn	Polyethylene (Non Conductor of Electricity)
02.	Discharge Valve	Confirms to IS : 3224 (Wheel type)
01.	Body	Seamless Manganese Steel - ISI Marked Confirms to IS : 7285

00.00.00	00.00.00		APP'D	A.Shah	01.07.15
00.00.00	00.00.00		CHK'D	Naresh	01.07.15
00.00.00	00.00.00		DR'N	RNG	01.07.15

KANEX
 (AN ISO-9001-2008 CERTIFIED CO.)
 KANADIA FYR FYTER PVT.LTD
 PLOT NO - 7, PARAS IND. ESTATE, NEAR GARIBISHA PIR,
 SIHOR -364 240.(GUJ.) e-mail: tech2@kanexfire.com

OWNER/CLIENT XXX XXX XX XXX XXX XXX XX			
CONTRACTOR XXX XXX XX XXX XXX XXX XX			
PO.No. XXX XXX XX XXX		TITLE CO ₂ TYPE FIRE EXTINGUISHER OF CAPACITY 2 KG.	
PROJECT	XXX XXX XX XXX	Scale	NTS
DRG.No.	KFPL/GAD/P/SHP/C/2	Project	
		Sheet	REV.
		1 of 1	00

Sr.No	Item Description	Materials of Constructions
1		
2		
3		
4		
5		
6		
7		
8		
9		
10		